

**ACCESSORIES
ZUBEHÖRTEILE
ACCESSOIRES**

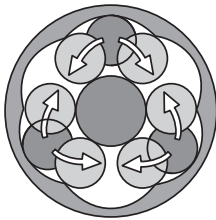

Z-SERIES
 HAND
 TITANIUM
 ACCESSORIES
 SCREWDRIVERS
 IMPACT
 SLEEVE-DRIVE
 PROTECTOR
 INDUSTRIAL
 AUTOMOTIVE
 MOTORCYCLE
 CONSTRUCTION
 SPARE PART

4100M / 4100A Stud Pullers
 Stehbolzendreher
 Extracteurs de goujons

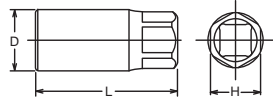

Stud Pullers
 Hexagon body design can lessen the excessive load on cages and rollers inside the pullers.

Stehbolzendreher
 Der neue Körper mit sechs Walzenmulden verteilt den Druck auf Käfig und Walzen weitaus vorteilhafter.

Extracteurs de goujons
 Le nouveau corps de forme hexagonale répartit l'effort de façon plus uniforme sur la cage et les rouleaux.

4100M (mm)	□	D (mm)	L (mm)	H (mm)	(g)	(pcs.)	
5	1/2"	24	65	21	145	10	
6		24	65	21	150	10	
7		24	65	21	150	10	
8		24	65	21	147	10	
9		28	75	21	217	10	
10		28	75	21	213	10	
10.5		28	75	21	202	10	
11		28	75	21	218	10	
12		28	75	21	220	10	
14		34	75	27	340	5	
16		-⚠	34	75	27	315	5

4100A (inch)	□	D (mm)	L (mm)	H (mm)	(g)	(pcs.)
1/4	1/2"	24	65	21	150	10
5/16		24	65	21	147	10
3/8		28	75	21	213	10
7/16		28	75	21	218	10
1/2		28	75	21	191	10
9/16		34	75	27	340	5
5/8	-⚠	34	75	27	315	5

* Renewal Kits → **4100MRK/4100ARK** → P321
 ⚠ 4100M-16 and 4100A-5/8 do not have 1/2" square drive.
 Drive the outer hexagon part with 27mm sockets or ring wrenches.
 Die Artikel 4100M 16mm und 4100A 5/8" haben keinen 1/2" Antriebsvierkant.
 Bitte benutzen Sie den 27mm Aussensechskant.
 Les articles 4100M-16 et 4100A-5/8" n'ont pas de carré entraînant 1/2" , veuillez utiliser l'hexagonal 6 pans 27 mm

Tolerance			
4100M (mm)		4100A (inch)	
5	4.7- 5	1/4	6 - 6.4
6	5.6- 6	5/16	7.6- 8
7	6.6- 7	3/8	9 - 9.6
8	7.6- 8	7/16	10.5-11.1
9	8.4- 9	1/2	12.1-12.7
10	9.4-10	9/16	13.5-14.3
10.5	9.9-10.5	5/8	15.2-16
11	10.4-11		
12	11.4-12		
14	13.2-14		
16	15.2-16		

4211M / 4211A Stud Pullers Sets
 Stehbolzendreher im Satz
 Jeu d'extracteurs de goujons



4211M 4 Pieces Set/△=1,040g
 METAL CASE:W215xH80xT47mm
 PULLER
 ○ 4100M Stud Pullers
 6, 8, 10, 12

4211A 4 Pieces Set/△=1,040g
 METAL CASE:W215xH80xT47mm
 PULLER
 ○ 4100A Stud Pullers
 1/4, 5/16, 3/8, 1/2

4214M Stud Pullers Set
 Stehbolzendreher im Satz
 Jeu d'extracteurs de goujons



4214M 5 Pieces Set/△=1,450g
 METAL CASE:W215xH80xT47mm
 PULLER
 ○ 4100M Stud Pullers
 6, 8, 10, 12, 14

6100M (mm)		D (mm)	L (mm)	H (mm)	(g)	(pcs.)
18	3/4"	48	100	36	840	1
20		48	100	36	816	1
22		48	100	36	745	1
24	-	48	100	36	739	1
27		63	125	46	1707	1
28		63	125	46	1701	1
29		63	125	46	1696	1
30		63	125	46	1691	1

* Renewal Kits → 6100MRK → P321

⚠ 6100M-22 to -30 do not have 3/4" square drive.
Drive the outer hexagon part with sockets or ring wrenches
(size 22-24mm = 36H, 27-30mm = 46H.)

Die Stehbolzendreher ab Abmessung 22mm haben keinen 3/4" Antriebsvierkant.
Bitte benutzen Sie den Aussensechskant.

Les extracteurs de goujon à partir de la dimension 22mm n'ont pas de carré d'entraînement 3/4".
Veuillez utiliser le l'hexagone extérieur.

Tolerance

6100M (mm)	
18	16.9-18
20	18.8-20
22	20.8-22
24	22.7-24
27	25.7-27
28	26.7-28
29	27.6-29
30	28.6-30

6100M Stud Pullers
Stehbolzendreher
Extracteurs de goujons

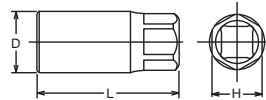

14100M (mm)		D ₁ (mm)	D ₂ (mm)	L (mm)	(g)	(pcs.)	
6	1/2"	24	25	48	126	10	*1
7		24	25	48	126	10	*1
8		24	25	48	122	10	*1
9		28	30	48	181	10	*2
10		28	30	48	181	10	*2
12		28	30	48	175	10	*2

14100A (inch)		D ₁ (mm)	D ₂ (mm)	L (mm)	(g)	(pcs.)	
1/4	1/2"	24	25	48	126	10	*1
5/16		24	25	48	122	10	*1
3/8		28	30	48	181	10	*2
7/16		28	30	48	181	10	*2
1/2		28	30	48	180	10	*2

*1 C-Ring=C41,Pin/O-Ring=A41/B41 → P268-269
*2 C-Ring=C42,Pin/O-Ring=A42/B42

Tolerance

14100M (mm)		14100A (inch)	
6	5.6- 6	1/4	6 - 6.4
7	6.6- 7	5/16	7.6- 8
8	7.6- 8	3/8	9 - 9.6
9	8.4- 9	7/16	10.5-11.1
10	9.4-10	1/2	12.1-12.7
12	11.4-12		

14100M / 14100A IMPACT Stud Pullers
IMPACT Stehbolzendreher
Extracteurs de goujons IMPACT

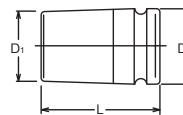

Stud Pullers & Setters

Stehbolzendreher

Extracteurs de goujons

Z-SERIES
HAND
TITANIUM
ACCESSORIES
SCREWDRIVERS
IMPACT
SLEEVE-DRIVE
PROTECTOR
INDUSTRIAL
AUTOMOTIVE
MOTORCYCLE
CONSTRUCTION
SPARE PART

4104 Stud Puller Stehbolzendreher Extracteurs de goujons

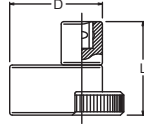

4104		Tolerance		D (mm)	L (mm)		
		min	max				
	1/2"	φ 6	φ 19	54	56	489	2

4103M / 4103A Stud Bolt Setters Stehbolzensetzer Monte-goujons

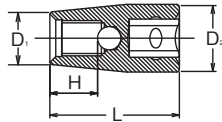

4103M (mm)		D ₁ (mm)	D ₂ (mm)	H (mm)	L (mm)		
6(1.0)	1/2"	10.3	22	9	37	54	10
7(1.0)		11.5	22	10	37	58	10
8(1.25)		13.2	22	11	37	60	10
10(1.25)		15.3	22.9	13	44	86	10
10(1.5)		15.3	22.9	13	44	86	10
12(1.25)		17.8	22.9	14	44	86	10
12(1.75)		17.8	22.9	14	44	86	10

4103A (inch)		D ₁ (mm)	D ₂ (mm)	H (mm)	L (mm)		
1/4(28)	1/2"	10.7	22	9	37	55	10
5/16(18)		13.2	22	11	37	61	10
5/16(24)		13.2	22	11	37	61	10
3/8(16)		14.6	22.9	12	44	84	10
7/16(14)		16.5	22.9	14	44	85	10
1/2(13)		19	22.9	14	44	88	10

Depend on the stud bolt and using torque, 4103M/13103M/14103M may cause a scratch against the stud bolts or got stuck itself during a work.

RS4103A/6 6-piece socket set on rail Steckschlüsselsatz auf Schiene Jeu de douilles sur rail



RS4103A/6	6 Pieces Set/Rail 200mm	
New	1/4(28), 5/16(18), 5/16(24), 3/8(16), 7/16(14), 1/2(13)	468

4203M Stud Bolt Setters Set Stehbolzensetzer im Satz Jeu de monte-goujons



4203M	4 Pieces Set =530g
METAL CASE: W130xH65xT26mm	
Stud Bolt Setter	
	4103M Stud Bolt Setters 6(1.0), 8(1.25), 10(1.5), 12(1.75)
4203MF	4 Pieces Set =530g
METAL CASE: W130xH65xT26mm	
Stud Bolt Setter	
	4103M Stud Bolt Setters 6(1.0), 8(1.25), 10(1.25), 12(1.25)

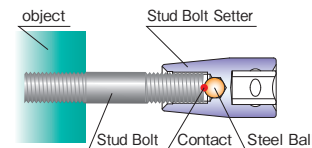

A special socket for installing a stud bolt.
Inside steel ball prevents the stud bolt stuck onto the socket. After installing a stud bolt, turn to anti-clockwise to removing the socket.

Spezialwerkzeug zum Setzen von Stehbolzen. Der Bolzen trifft im Werkzeug nur auf die gehärtete Stahlkugel, was die Kontaktfläche verringert. Nach dem Setzen des Stehbolzens kann das Werkzeug im Linkslauf vom Stehbolzen abgezogen werden.

Douilles spéciales pour monter les goujons.
Le goujon est en contact avec une bille d'acier pour l'empêcher d'adhérer à la douille.
Après avoir posé le goujon, tourner dans le sens antihorlogique pour le retirer

13103M (mm)		D ₁ (mm)	D ₂ (mm)	H (mm)	L (mm)	(g)	(pcs.)	
5(0.8)	3/8"	9.5	19	8	32	39	10	*1
6(1.0)		10.8	19	9	32	41	10	*1
7(1.0)		12.5	19	10	32	44	10	*1
8(1.25)		13.5	19	11	35	49	10	*1
10(1.25)		15.8	19	13	35	49	10	*1
10(1.5)		15.8	19	13	35	49	10	*1

*1 C-Ring=C31, Pin/O-Ring=A31/B31 → P268-269

14103M (mm)		D ₁ (mm)	D ₂ (mm)	H (mm)	L (mm)	(g)	(pcs.)	
6(1.0)	1/2"	12	25	11	42	75	10	*1
7(1.0)		13.2	25	12	42	78	10	*1
8(1.25)		14.5	25	15	42	81	10	*1
10(1.25)		17	25	18	49	106	10	*1
10(1.5)		17	25	18	49	106	10	*1
12(1.25)		19.5	25	19	49	107	10	*1
12(1.75)		19.5	25	19	49	107	10	*1
14(1.5)	22	25	21	55	128	10	*1	
14(2.0)	22	25	21	55	128	10	*1	

*1 C-Ring=C41, Pin/O-Ring=A41/B41 → P268-269

⚠ Depending on the stud bolt and the used torque, 4103M/13103M/14103M may cause scratches on the stud bolts or get stuck during work.

Je nach Gewindebolzen und verwendetem Drehmoment kann es zu Kratzern kommen oder dass sie während der Arbeit stecken bleiben.

Selon le monte-goujon et le couple utilisé, 4103M/13103M/14103M peut causer des rayures ou même bloquer pendant le travail.

13103M ○ Impact Stud Bolt Setters Impact Stehbolzensetzer Monte-goujons Impact ⚠

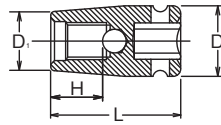

14103M ○ Impact Stud Bolt Setters Impact Stehbolzensetzer Monte-goujons Impact ⚠

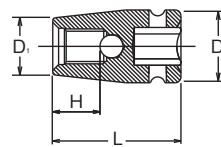

23103M (mm)		D ₁ (mm)	D ₂ (mm)	H (mm)	L (mm)	(g)	(pcs.)	
6(1.0)	3/8"	11.1	22	9	59	175	10	*1
8(1.25)		13.6	22	11	61	181	10	*1
10(1.25)		16	22	13	63	188	10	*1
10(1.5)		16	22	13	63	188	10	*1

*1 C-Ring=C32, Pin/O-Ring=A32/B32 → P268-269

23103M ○ Stud Bolt Setter with unlocking system Stehbolzensetzer mit Entriegelungssystem Monte-goujons avec système de déverrouillage ⚠

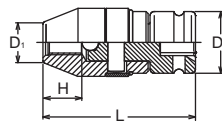

24103M (mm)		D ₁ (mm)	D ₂ (mm)	H (mm)	L (mm)	(g)	(pcs.)	
8(1.25)	1/2"	15.4	30	15	69	332	5	*1
10(1.25)		17.8	30	18	72	344	5	*1
10(1.5)		17.8	30	18	72	344	5	*1
12(1.75)		20.2	30	19	74	352	5	*1

*1 C-Ring=C42, Pin/O-Ring=A42/B42 → P268-269

⚠ This item is not suitable for Impact Drivers.
Das Werkzeug ist nicht für Schlagschrauber geeignet.
Ne pas utiliser avec visseuses à choc.

24103M ○ Stud Bolt Setter with unlocking system Stehbolzensetzer mit Entriegelungssystem Monte-goujons avec système de déverrouillage ⚠

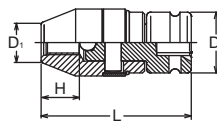

23103M/24103M -Stud Bolt Setter with unlocking system-

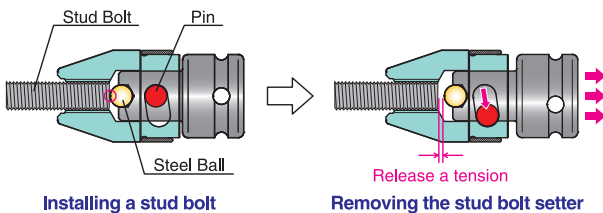

The stud setter has an unlocking system that allows the tool to be easily unscrewed from the stud.

Der Stehbolzensetzer verfügt über ein Entriegelungssystem dadurch lässt sich das Werkzeug ganz leicht vom Stehbolzen abdrehen.

L'outil de pose de goujons dispose d'un système de déverrouillage qui permet de le détacher facilement du goujon.

Tap Holder / Die Holder
 Halter für Gewindeschneider / Halter für Gewindeschneideisen
 Porte taraud / Porte-filière

Z-SERIES
 HAND
 TITANIUM
 ACCESSORIES
 SCREWDRIVERS
 IMPACT
 SLEEVE-DRIVE
 PROTECTOR
 INDUSTRIAL
 AUTOMOTIVE
 MOTORCYCLE
 CONSTRUCTION
 SPARE PART

3131E Tap Holder
 Halter für Gewindeschneider
 Porte taraud / porte-filière

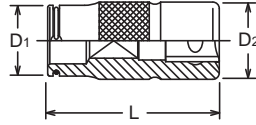

3131E	□	D ₁ (mm)	D ₂ (mm)	L (mm)	(g)	(pcs.)
□2.1x	□2.8	6.8	18	40	45	10
□2.7x	□3.5	8	18	40	46	10
□3.4x	□4.5	9.5	18	40	47	10
□4.9x	□6	11.5	18	40	48	10
□5.5x	□7	12.5	18	40	49	10
□7	x □9	15	18	40	48	10
□9	x □11	17	18	40	48	10
□9	x □12	18	18	40	48	10

For DIN352, DIN351, DIN2181, DIN5157 tap

3264 Tap Holder set 10 pieces
 Halter für Gewindeschneider im Satz
 Jeu de portes taraud



3264		10 Pieces Set/ 1.050g	
METAL CASE: W240xH100xT32mm			
Sockets		Accessories	
□	3131E □2.1x□2.8, □2.7x□3.5, □3.4x□4.5, □4.9x□6, □5.5x□7, □7x□9, □9x□11, □9x□12,		160K
□			3760-125

3131A Adjustable Tap Holder
 Halter für Gewindeschneider, einstellbar
4131A Porte taraud, ajustable

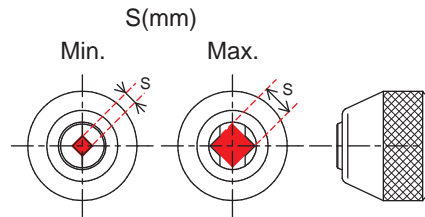
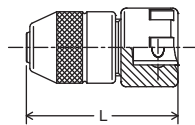

3131A	□	S (mm)		L (mm)	(g)	(pcs.)
		Min.	Max.			
1	□3/8"	2.0	5.0	42	80	5
2	□3/8"	4.5	8.0	47	100	5

4131A	□	S (mm)		L (mm)	(g)	(pcs.)
		Min.	Max.			
3	□1/2"	5.5	12	69	400	2

160K Reversible Ratchet
 Verstellbare Knarre
 Cliquet réversible

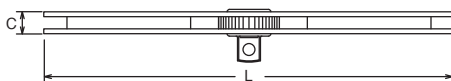

Tap is not included.
 Gewindeschneider, nicht enthalten.
 Taraud non inclus.

	□	C (mm)	L (mm)	(g)	(pce.)
160K	□3/8"	10	220	130	1
160K-1/2	□1/2"	10	220	135	1

3132 Die Holder
 Halter für Gewindeschneideisen
4132 Porte-filière

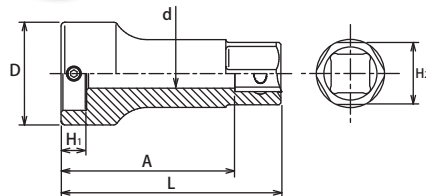

	□	D (mm)	H ₁ (mm)	H ₂ (mm)	d (mm)	A (mm)	L (mm)	(g)	(pcs.)
3132-20	□3/8"	28	7	17	8	45	60	130	5
4132-25		34	9	22	14	40	60	170	2
4132-38	□1/2"	48	13	24	18	60	80	315	2
4132-50		60	16	27	30	85	105	740	2



Die is not included.
 Gewindeschneideisen nicht enthalten.
 Filière non inclus.

2127 (mm)		D ₁ (mm)	D ₂ (mm)	H (mm)	L (mm)	(g)	(pcs.)
4	1/4"	7	13	4	23	14	10
4.5		7.4	13	4	23	14	10
5		8	13	5	23	14	10
5.5		8.8	13	5	23	14	10
6		9.5	13	6	23	14	10
7		10.9	13	6	23	14	10
8		11.5	13	8	23	14	10
9		13	13	8	23	15	10
9.5		13.8	13	10	23	16	10
10		14.8	13	10	23	17	10



2127 NUTTWISTER®

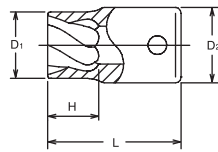

RS2127/6	6 Pieces Set/Rail 150mm	(g)
4, 4.5, 5, 5.5, 6, 7		105

RS2127/6 Socket Set on Rail
Steckschlüsselsatz auf Schiene
Jeu de douilles sur rail



RS2127/10	10 Pieces Set/Rail 150mm	(g)
4, 4.5, 5, 5.5, 6, 7, 8, 9, 9.5, 10		180

RS2127/10 Socket Set on Rail
Steckschlüsselsatz auf Schiene
Jeu de douilles sur rail



3127 (mm)		D ₁ (mm)	D ₂ (mm)	H (mm)	L (mm)	(g)	(pcs.)
8	3/8"	11.5	19	8	32	40	10
9		13	19	8	32	40	10
9.5		13.8	19	8	32	41	10
10		14.8	19	10	32	41	10
11		16	19	10	32	43	10
12		17	19	12	32	44	10
13		18.5	19	12	32	46	10
14		19.7	19	14	32	48	10
15		20.7	19	14	32	52	10
16		22.2	22	14	32	66	10
17	23.5	22	16	35	80	10	
19	26	22	16	35	92	10	

3127 NUTTWISTER®

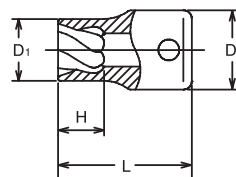

RS3127/8	8 Pieces Set/Rail 200mm	(g)
8, 9, 10, 11, 12, 13, 14, 16		420

RS3127/8 Socket Set on Rail
Steckschlüsselsatz auf Schiene
Jeu de douilles sur rail



3128-80 (mm)		D ₁ (mm)	D ₂ (mm)	H (mm)	L (mm)	(g)	(pcs.)
8	3/8"	11.5	19	6	80	58	10
9		13	19	6	80	61	10
10		14.8	19	8	80	66	10
11		16	19	8	80	70	10
12		17	19	10	80	77	10
13		18.5	19	10	80	80	10
14		19.7	19	12	80	82	10

3128 (L80) NUTTWISTER® (Long type)

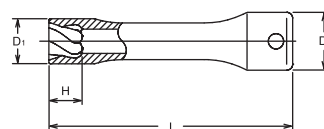

Z-SERIES
HAND
TITANIUM
ACCESSORIES
SCREWDRIVERS
IMPACT
SLEEVE-DRIVE
PROTECTOR
INDUSTRIAL
AUTOMOTIVE
MOTORCYCLE
CONSTRUCTION
SPARE PART

4127  NUTTWISTER®

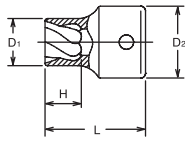

4127 (mm)		D ₁ (mm)	D ₂ (mm)	H (mm)	L (mm)	(g)	(pcs.)
14	1/2"	19.7	30	14	42	125	10
17		23.5	30	16	42	137	10
19		26	30	16	42	146	10
21		28	30	17	42	153	10
22		29.5	30	17	42	158	10
24		32	30	18	42	174	10
25.4		33.5	30	18	42	183	10

RS4127/6   Socket Set on Rail
Steckschlüsselsatz auf Schiene
Jeu de douilles sur rail



RS4127/6	6 Pieces Set/Rail 200mm	(g)
17, 19, 21, 22, 24, 25.4		960

4128 (L120)  NUTTWISTER® (Long type)

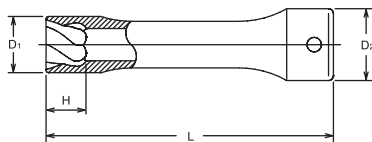

4128-120 (mm)		D ₁ (mm)	D ₂ (mm)	H (mm)	L (mm)	(g)	(pcs.)
17	1/2"	23.5	30	16	120	227	5
19		26	30	16	120	247	5
21		28	30	17	120	262	5
22		29.5	30	17	120	259	5

A very effective method and easy solution for removing rounded off nuts, bolts and studs. The sharp edges of the NUTTWISTER® Socket opening will tighten around the nut, bolt or stud and turn it easily off.

Eine einfache und wirkungsvolle Methode rund gedrehte Muttern und Bolzen herausdrehen bzw. zu öffnen.

Die scharfen Kanten der gewundenen NUTTWISTER® Öffnung setzen sich um die Mutter bzw. den Schraubenkopf und drehen sie problemlos heraus.

Il existe une méthode simple mais efficace pour retirer les écrous et les boulons arrondis ainsi que les goujons et les dispositifs de verrouillage des jantes.

Les arêtes vives de la douille NUTTWISTER® vont «mordre» l'écrou, le boulon ou le goujon et permettre ainsi facilement son extraction.



3129-32 (mm)		D ₁ (mm)	D ₂ (mm)	L (mm)	(g)	(pcs.)
2	3/8"	2	19	32	32	10
3		3	19	32	33	10
4		4	19	32	33	10
6		6	19	32	35	10
8		8	19	32	37	10
10		10	19	32	40	10

3129-60 (mm)		D ₁ (mm)	D ₂ (mm)	L (mm)	(g)	(pcs.)
2	3/8"	2	19	60	38	10
3		3	19	60	42	10
4		4	19	60	44	10
6		6	19	60	47	10
8		8	19	60	53	10
10		10	19	60	64	10

RS3129/6-L32	6 Pieces Set/Rail 150mm	(g)
2, 3, 4, 6, 8, 10		250

RS3129/6-L60	6 Pieces Set/Rail 150mm	(g)
2, 3, 4, 6, 8, 10		320

4129-37 (mm)		D ₁ (mm)	D ₂ (mm)	L (mm)	(g)	(pcs.)
8	1/2"	8	24	37	59	10
10		10	24	37	63	10
12		12	24	37	67	10
14		14	24	37	72	10
16		16	24	37	78	10

4129-75 (mm)		D ₁ (mm)	D ₂ (mm)	L (mm)	(g)	(pcs.)
8	1/2"	8	24	75	80	10
10		10	24	75	94	10
12		12	24	75	110	10
14		14	24	75	130	10
16		16	24	75	150	10

RS4129/5-L37	5 Pieces Set/Rail 150mm	(g)
8, 10, 12, 14, 16		370

RS4129/5-L75	5 Pieces Set/Rail 150mm	(g)
8, 10, 12, 14, 16		600



3129-32 / -60 BOLTTWISTER®

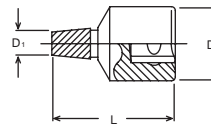

RS3129/6-L32 / -L60

Socket Set on Rail
Steckschlüsselsatz auf Schiene
Jeu de douilles sur rail



4129-37 / -75 BOLTTWISTER®

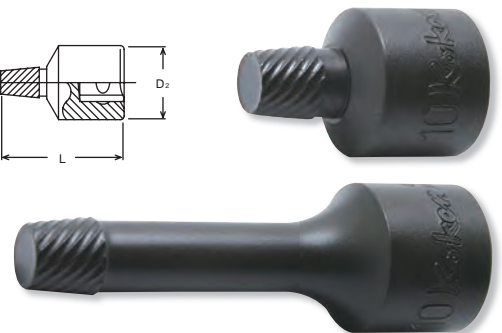
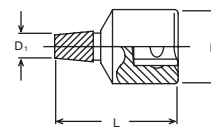

RS4129/5-L37 / -L75

Socket Set on Rail
Steckschlüsselsatz auf Schiene
Jeu de douilles sur rail

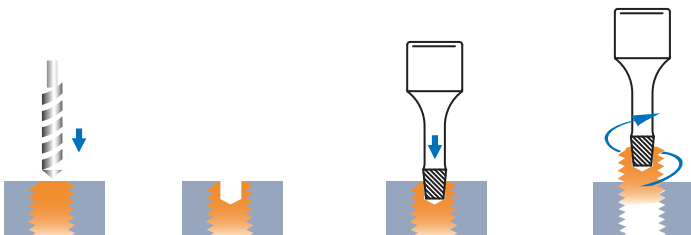

Effective method and easy solution for removing twisted of bolt. Drill a hole in the center of bolt and drive BOLTTWISTER® firmly into the hole. The sharp Spirals edges will hold the broken bolt and easily remove it.

Eine effektive Methode und einfache Lösung zum Entfernen von verdrehten Schrauben. Bohren Sie ein Loch in die Mitte der Schraube und treiben Sie den BOLTTWISTER fest in das Loch. Die scharfen Spiralkanten halten die gebrochene Schraube fest und entfernen diese leicht.

Une méthode efficace et une solution simple pour enlever les vis tordues. Percez un trou au centre de la vis et enfoncez fermement le BOLTTWISTER dans le trou. Les arêtes hélicoïdales tranchantes maintiennent la vis cassée et permettent de la retirer facilement.

BOLTTWISTER	Bolt size	Drill size
2	M5	φ 2.4 ~ 2.6
3	M6	φ 3.2 ~ 3.5
4	M8	φ 4.2 ~ 4.5
6	M10 ~ M12	φ 6.2 ~ 6.5
8	M14 ~ M16	φ 8.2 ~ 8.5
10	M18 ~ M20	φ 10.2 ~ 10.5
12	M22 ~ M24	φ 12.2 ~ 12.5
14	M27 ~ M30	φ 14.2 ~ 14.5
16	M33	φ 16.2 ~ 16.5

Ratcheting Ring Spanners

Knarren-Ringschlüssel

Clés hexagonales à cliquet

Z-SERIES
HAND
TITANIUM
ACCESSORIES
SCREWDRIVERS
IMPACT
SLEEVE-DRIVE
PROTECTOR
INDUSTRIAL
AUTOMOTIVE
MOTORCYCLE
CONSTRUCTION
SPARE PART

102NM / 102NA Without reverse lever Nicht umstellbar Non réversible

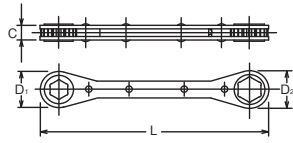

102NM (mm)	L (mm)	D ₁ (mm)	D ₂ (mm)	C (mm)	(g)	(pcs.)
6x7	108	15.3	16.4	7.5	60	10
7x8	108	15.3	16.4	7.5	60	10
8x9	134	17.1	19.7	7.5	80	10
8x10	134	17.1	19.7	7.5	80	10
10x11	140	20.1	22.7	7.5	87	10
10x12	140	20.1	22.7	7.5	87	10
11x13	145	23.6	24.6	9	112	10
12x13	145	23.6	24.6	9	112	5
12x14	145	23.6	24.6	9	112	5

102NA (inch)	L (mm)	D ₁ (mm)	D ₂ (mm)	C (mm)	(g)	(pcs.)
7/32 x 1/4	108	15.3	16.4	7.5	60	10
1/4 x 9/32	108	15.3	16.4	7.5	60	10
1/4 x 5/16	108	15.3	16.4	7.5	60	10
5/16 x 11/32	134	17.1	19.7	7.5	80	10
5/16 x 3/8	134	17.1	19.7	7.5	80	10
3/8 x 7/16	140	20.1	22.7	7.5	87	10
7/16 x 1/2	145	23.6	24.6	9	112	10
1/2 x 9/16	145	23.6	24.6	9	112	5

102KM / 102KA Reversible Umstellbar Réversible

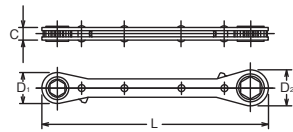

102KM (mm)	L (mm)	D ₁ (mm)	D ₂ (mm)	C (mm)	(g)	(pcs.)
6x7	108	15.3	16.4	7.2	51	10
7x8	108	15.3	16.4	7.2	51	10
8x9	134	17	20	9.1	76	10
8x10	134	17	20	9.1	76	10
10x11	141	21	23.5	9.1	84	10
10x12	141	21	23.5	9.1	84	10
12x13	146	24	25	9.1	89	10
12x14	146	24	25	9.1	89	5
13x17	200	27.1	31.8	11.5	190	5
14x17	200	27.1	31.8	11.5	200	5

102KA (inch)	L (mm)	D ₁ (mm)	D ₂ (mm)	C (mm)	(g)	(pcs.)
7/32 x 1/4	108	15.3	16.4	7.2	51	10
1/4 x 5/16	108	15.3	16.4	7.2	51	10
5/16 x 11/32	134	17	20	9	76	10
3/8 x 7/16	141	21	23.5	9.1	84	10
1/2 x 9/16	146	24	25	9.1	89	5

102KM.BH With Twin Openings (Two-in-One) Doppel-Ringschlüssel (zwei Öffnungen in einer) Ouvertures doubles

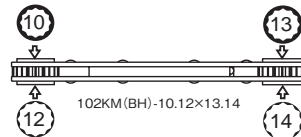

102KM.BH (mm)	L (mm)	D ₁ (mm)	D ₂ (mm)	C (mm)	(g)	(pcs.)
5.5- 6x 7- 8	108	15.3	16.4	10	60	10
8 ·10x12·13	141	21	23.5	13	87	10
9 ·10x11·12	141	21	23.5	13	87	10
10 ·12x13·14	146	24	25	13	98	10
13 ·14x15·17	200	27.1	31.8	16	200	5

102KT Reversible TORX® Umstellbar TORX® Réversible TORX®



102KT (E)	L (mm)	D ₁ (mm)	D ₂ (mm)	C (mm)	(g)	(pcs.)
E 4xE 6	108	15.3	16.4	7.5	51	10
E 6xE 8	108	15.3	16.4	7.5	51	10
E10xE12	134	17	20	9	76	10

103KM (mm)	L (mm)	D ₁ (mm)	D ₂ (mm)	C (mm)	(g)	(pcs.)
6x 7	108	15.3	16.4	7.5	51	5
7x 8	108	15.3	16.4	7.5	51	5
8x 9	134	17	20	9	76	5
8x10	134	17	20	9	76	5
10x11	140	21	23.5	9	84	5
10x12	140	21	23.5	9	84	5
12x13	145	24	25	9	89	5
12x14	145	24	25	9	89	5

103KA (inch)	L (mm)	D ₁ (mm)	D ₂ (mm)	C (mm)	(g)	(pcs.)
7/32x 1/4	108	15.3	16.4	7.5	51	5
1/4 x 5/16	108	15.3	16.4	7.5	51	5
5/16x11/32	134	17	20	9	76	5
5/16x 3/8	134	17	20	9	76	5
3/8 x 7/16	140	21	23.5	9	84	5
7/16x 1/2	145	24	25	9	89	5
1/2 x 9/16	145	24	25	9	89	5

103KA.BH (inch)	L (mm)	D ₁ (mm)	D ₂ (mm)	C (mm)	(g)	(pcs.)
1/4x5/16	108	15.3	16.4	7.5	51	5
3/8x7/16	140	21	23.5	9	84	5
1/2x9/16	145	24	25	9	89	5

103KT (E)	L (mm)	D ₁ (mm)	D ₂ (mm)	C (mm)	(g)	(pcs.)
E 4xE 6	104	15.3	16.4	7.5	51	5
E 6xE 8	104	15.3	16.4	7.5	51	5
E10xE12	128	17	20	9	76	5
E14xE16	139	24	25	9	89	5

145KM (mm)	L (mm)	D (mm)	C (mm)	(g)	(pcs.)
10H	125	20.1	7.5	72	10



150-10H (mm)	D (mm)	H (mm)	L (mm)	(g)	(pcs.)
5	12	3.5	11	6	10
6	12	4.5	12.5	7	10
7	12	5	14	7	10
8	12	6	15.5	7	10
9	13	6	16	7	10
10	14.3	7	17	9	10
12	17.4	9	19.5	14	10

1203		7 Pieces Set/△=250g	
METAL CASE:W130xH65xT20mm			
Sockets		Accessory	
150.10H	5, 6, 7, 8, 9, 10		145KM-10H

103KM / 103KA Reversible
Umstellbar
Réversible

103KA.BH Reversible (12P)
Umstellbar (12P)
Réversible (12P)

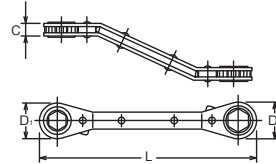

103KT Reversible TORX®
Umstellbar TORX®
Réversible TORX®

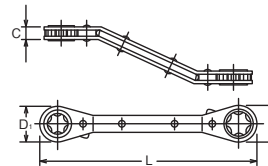

145KM-10H Reversible, 10mm 6-pt.
Verstellbar SW10mm
Réversible 10mm

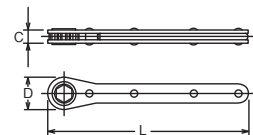

150-10H Sockets with 10mm 6-point Drive End
Steckschlüssel mit 10mm Sechskant-Antrieb
Douilles à conducteur de 10mm 6-pans mâle

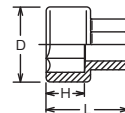

1203 Sockets with 10mm 6-point Drive End in Set with Ratchet
Steckschlüssel mit 10mm Sechskant-Antrieb mit Knarre im Satz
Jeu de douilles à conducteur 10mm 6-pans mâle, avec cliquet





Ratcheting Ring Spanners
 Knarren-Ringschlüssel
 Clés hexagonales à cliquet

Z-SERIES
 HAND
 TITANIUM
 ACCESSORIES
 SCREWDRIVERS
 IMPACT
 SLEEVE-DRIVE
 PROTECTOR
 INDUSTRIAL
 AUTOMOTIVE
 MOTORCYCLE
 CONSTRUCTION
 SPARE PART

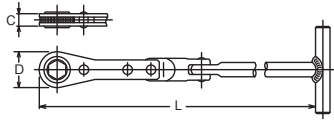

154M  Push and Pull-Ratchets
 Hub-Knarren
 Clé à cliquet de levage



154M (mm)	L (mm)	D (mm)	C (mm)	 (g)	 (pcs.)
8	294	17.1	7.5	178	2
10	297	20.1	7.5	183	2
12	300	23.6	9	189	2
13	301	24.6	9	194	2
14	301	24.6	9	194	2



154ML  Push and Pull-Ratchets
 Hub-Knarren
 Clé à cliquet de levage

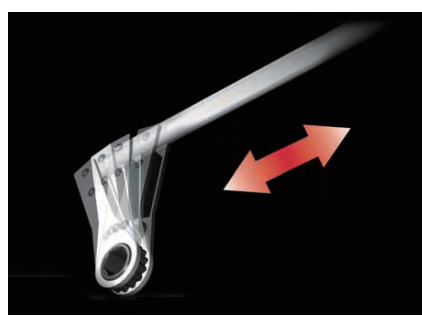
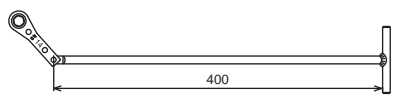

154ML (mm)	L (mm)	D (mm)	C (mm)	 (g)	 (pcs.)
10	297	20.1	7.5	230	2
12	300	23.6	9	252	2

1206  Push and Pull-Ratchet
 Hub-Knarre
 Clé à cliquet de levage



1206		3 Pieces Set/  =320g
CARDBOARD BOX		
Sockets		Accessory
 150.14H Sockets 12, 14	154K-14	

Ratcheting Ring Spanners Knarren-Ringschlüssel Clés hexagonales à cliquet

137	L (mm)	D ₁ (mm)	D ₂ (mm)	C (mm)	(g)	(pcs.)
	141	23.5	21	9	104	5

1/4" × 3/8"

138	L (mm)	D ₁ (mm)	D ₂ (mm)	C (mm)	(g)	(pcs.)
	141	23.5	21	9	97	10

1/4" × 1/4"

139	L (mm)	D (mm)	C (mm)	(g)	(pcs.)
	125	20.1	7.5	80	10

1/4"

R810 (inch)	L (mm)	D ₁ (mm)	D ₂ (mm)	C (mm)	(g)	(pcs.)
1/4×5/16	108	15.3	16.4	7.5	60	10
3/8×7/16	140	20.1	22.7	7.5	87	10
1/2×9/16	145	23.6	24.6	9	112	10

137 For 1/4" and 3/8" Square Drive Sockets
Für Steckschlüssel mit 1/4" und 3/8" Antrieb
Pour douilles d'un carré conducteur de 1/4" et 3/8"

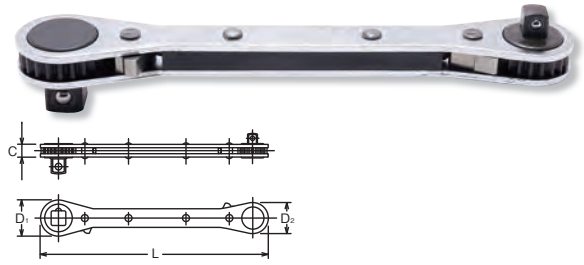

138 For Bits 101
Für Klängen 101
Pour embouts 101

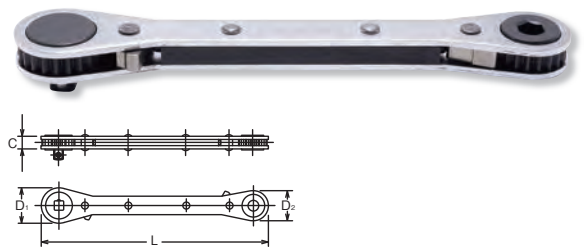

139 For 1/4" Square Drive Sockets
Für Steckschlüssel mit 1/4" Antrieb
Pour douilles d'un carré conducteur de 1/4"

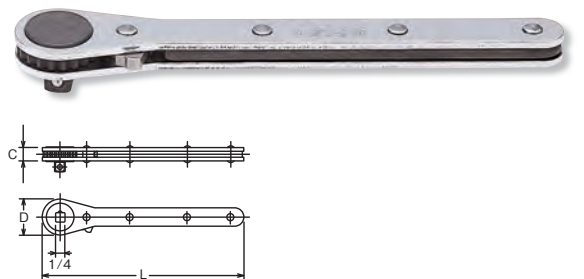

R810 Reversible (12P)
Umstellbar (12P)
Réversible (12P)

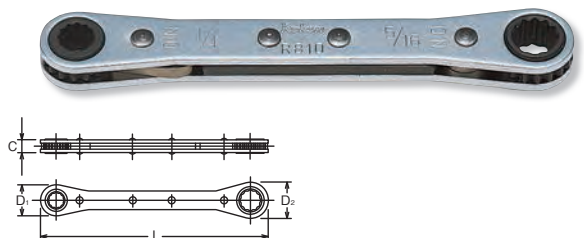

Z-SERIES
HAND
TITANIUM
ACCESSORIES
SCREWDRIVERS
IMPACT
SLEEVE-DRIVE
PROTECTOR
INDUSTRIAL
AUTOMOTIVE
MOTORCYCLE
CONSTRUCTION
SPARE PART

Ratcheting Ring Spanners

Knarren-Ringschlüssel

Clés hexagonales à cliquet

Z-SERIES
HAND
TITANIUM
ACCESSORIES
SCREWDRIVERS
IMPACT
SLEEVE-DRIVE
PROTECTOR
INDUSTRIAL
AUTOMOTIVE
MOTORCYCLE
CONSTRUCTION
SPARE PART

101P PH Bits PH Bits Embouts, PH



101P (PH)	D (mm)	L (mm)	(g)	(pcs.)
1	6.35	20.5	3	10
2	6.35	20.5	4	10
3	6.35	20.5	5	10

101S Slotted Bits Schlitz Bits Embouts, fente

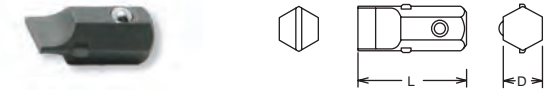

101S	D (mm)	L (mm)	(g)	(pcs.)
1.0x7	6.35	15	3	10
1.2x7	6.35	15	3	10

101H Hex Bits Sechskant Bits Embouts, 6 pans creux

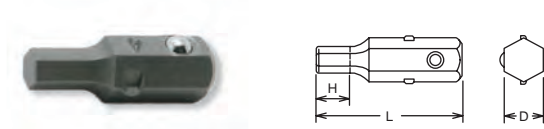

101H (mm)	D (mm)	H (mm)	L (mm)	(g)	(pcs.)
3	6.35	6	20.5	5	10
4	6.35	6	20.5	5	10
5	6.35	6	20.5	5	10
6	6.35	6.5	20.5	5	10
7	6.35	-	20.5	6	10
8	6.35	-	20.5	7	10

101B Ball-point Hex Bits Sechskant Bits Embouts, 6 pans creux



101B (mm)	D (mm)	L (mm)	(g)	(pcs.)
3	6.35	25	4	10
4	6.35	25	4	10
5	6.35	25	5	10
6	6.35	25	5	10

 Ball point bits have less strength due to the special design. Make sure to use them correctly.

101T (T) TORX® Bits TORX® Bits Embouts, TORX®

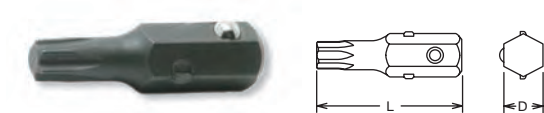

101T (T)	D (mm)	L (mm)	(g)	(pcs.)
T 9	6.35	25	4	10
T10	6.35	25	4	10
T15	6.35	25	5	10
T20	6.35	25	5	10
T25	6.35	25	5	10
T27	6.35	25	6	10
T30	6.35	25	6	10

101T (TH) Tamper-Resistant TORX® Bits TORX® Bits Embouts, TORX®



101T (TH)	D (mm)	L (mm)	(g)	(pcs.)
T10H	6.35	25	4	10
T15H	6.35	25	4	10
T20H	6.35	25	5	10
T25H	6.35	25	5	10
T27H	6.35	25	6	10
T30H	6.35	25	6	10

 Tamper Resistant TORX® Bits have less strength due to special design. Make sure to use it correctly.

128H (mm)	D (mm)	H (mm)	L (mm)	(g)	(pcs.)
3	8	6	32	11	10
4	8	6	32	11	10
5	8	6	32	12	10
6	8	8	32	12	10
8	8	-	32	13	10

128T (T)	D (mm)	L (mm)	(g)	(pcs.)
T10	8	32	9	10
T15	8	32	9	10
T20	8	32	9	10
T25	8	32	10	10
T27	8	32	10	10
T30	8	32	11	10

101A	D (mm)	S (mm)	L (mm)	(g)	(pcs.)
	8	6.35	20	8	10

128H Hex Bits
Sechskant Bits
Embouts, 6 pans creux



128T TORX® Bits
TORX® Bits
Embouts, TORX®



101A Adaptor
Verbindungsstück
Adaptateur

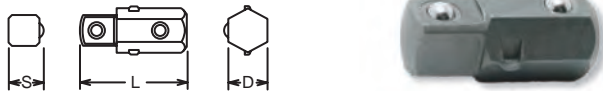

1202		15 Pieces Set/15=420g
METAL CASE:W190xH60xT30mm		
Bits	Accessory	
<p>101P PH Bits 1, 2, 3</p> <p>101S Slotted Bit 1x7</p> <p>101B Ballpoint Hex Bits 3, 4, 5, 6</p> <p>101T TORX® Bits T10, T15, T20, T25, T27, T30</p>	138	

1202 Bit Set
Bit-Satz
Jeu d'embouts



2254M		12 Pieces Set/12=450g
METAL CASE:W160xH100xT28mm		
Bits	Accessories	
<p>101P PH Bits 1, 2, 3</p> <p>101S Slotted Bits 1x7, 1.2x7</p> <p>101H Hex Bits 3, 4, 5</p>	102NA-1/4x5/16 2769F 101A 2137	

2254M Bit Set
Bit-Satz
Jeu d'embouts



Ratcheting Ring Spanners Knarren-Ringschlüssel Clés hexagonales à cliquet

Z-SERIES
HAND
TITANIUM
ACCESSORIES
SCREWDRIVERS
IMPACT
SLEEVE-DRIVE
PROTECTOR
INDUSTRIAL
AUTOMOTIVE
MOTORCYCLE
CONSTRUCTION
SPARE PART

R810A Bit Set
Bit-Satz
Jeu d'embouts



R810A 5 Pieces Set/△=208g	
METAL CASE:W130xH65xT20mm	
Bits	Accessory
101P PH Bits 1, 2, 3 101S Slotted Bit 1x7	102NA-1/4x5/16

R810B Bit Set
Bit-Satz
Jeu d'embouts



R810B 10 Pieces Set/△=268g	
METAL CASE:W130xH65xT20mm	
Bits	Accessory
101P PH Bits 1, 2, 3 101S Slotted Bit 1x7 128H Hex Bits 3, 4, 5, 6, 8	102NA-1/4x5/16

R810C Bit and Socket Set
Bit und Steckschlüssel Satz
Jeu de douilles et d'embouts



R810C 12 Pieces Set/△=227g	
METAL CASE:W130xH65xT20mm	
Bits, Sockets	Accessories
101P PH Bits 1, 2, 3 101S Slotted Bit 1x7 2400M Sockets 5, 6, 7, 8, 9, 10	102NA-1/4x5/16 101A

R810D Bit and Socket Set
Bit und Steckschlüssel Satz
Jeu de douilles et d'embouts



R810D 17 Pieces Set/△=336g	
METAL CASE:W130xH65xT20mm	
Bits, Sockets	Accessories
101P PH Bits 1, 2, 3 101S Slotted Bit 1x7 128H Hex Bits 3, 4, 5, 6, 8 2400M Sockets 5, 6, 7, 8, 9, 10	102NA-1/4x5/16 101A

R810E Socket Set
Steckschlüssel Satz
Jeu de clés à douilles



R810E 9 Pieces Set/△=445g	
METAL CASE:W130xH65xT20mm	
Sockets	Accessories
2300M Deep Sockets 6, 7, 8, 9, 10, 11, 12	102NA-1/4x5/16 101A



156M  6-Point Deep
6-kant, lang
Longues 6-pans

156M (mm)	D (mm)	H ₁ (mm)	H ₂ (mm)	L ₁ (mm)	L ₂ (mm)	(g)	(pce.)
8	12	9	41	355	200	231	1
10	14.5	11	41	355	200	289	1
12	16.8	13	41	355	200	429	1
14	20	16	41	355	200	454	1

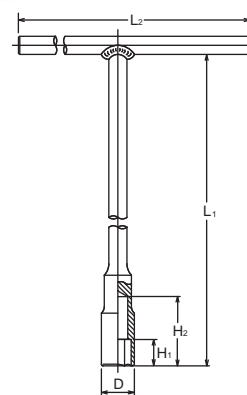

104ME / 104A  6-Point
6-kant
6-pans

104ME (mm)	D (mm)	H (mm)	L ₁ (mm)	L ₂ (mm)	(g)	(pce.)
6	9.5	8	200	180	150	1
7	11	9	200	180	152	1
8	12	10	250	200	183	1
9	14	12	250	200	188	1
10	14	13	250	200	230	1
11	16	14	250	200	234	1
12	18	15	250	200	355	1
13	18.5	17	250	250	390	1
14	20	18	250	250	399	1
15	21	19	250	250	404	1
16	22.5	21	250	250	419	1
17	24	22	250	250	568	1
18	25	23	250	250	577	1
19	26.5	25	250	250	594	1
21	29	27	350	300	1070	1
22	30	28	350	300	1062	1
24	33	30	350	300	1140	1

104A (inch)	D (mm)	H (mm)	L ₁ (mm)	L ₂ (mm)	(g)	(pce.)
1/4	9.5	8	200	180	150	1
5/16	12	10	250	200	183	1
3/8	14	12	250	200	188	1
7/16	16	14	250	200	234	1
1/2	18.5	17	300	250	412	1
9/16	20	18	300	250	428	1
5/8	22.5	21	350	300	528	1
3/4	26.5	25	350	300	717	1

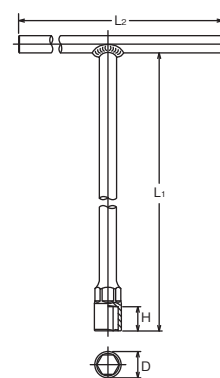
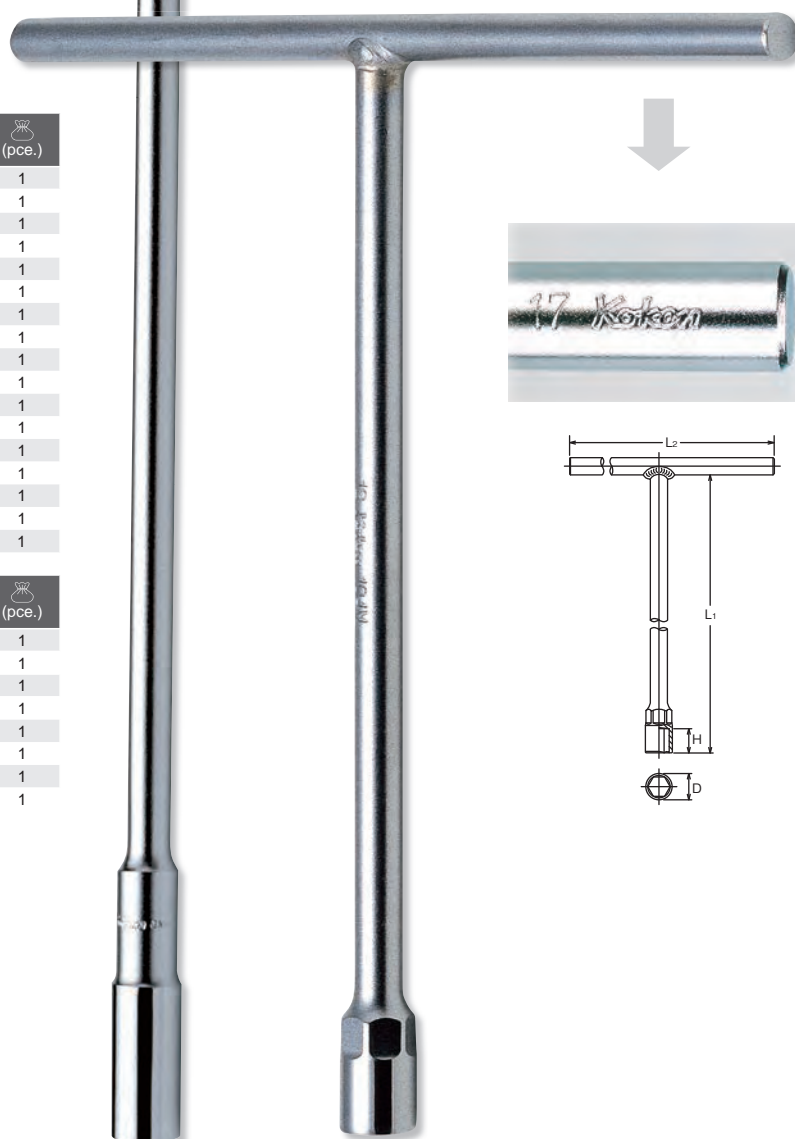

Z-SERIES
HAND
TITANIUM
ACCESSORIES
SCREWDRIVERS
IMPACT
SLEEVE-DRIVE
PROTECTOR
INDUSTRIAL
AUTOMOTIVE
MOTORCYCLE
CONSTRUCTION
SPARE PART

3116M

○ Universal with 6-point Socket
Gelenk mit 6-kant Steckschlüssel
Cardan avec douille 6-pans



124M-600 (2B)

○ Ball Joint plus Nut Grip Socket
Kugelgelenk mit 2-facher Kugelhalterung
Douilles articulées avec deux billes de retenue

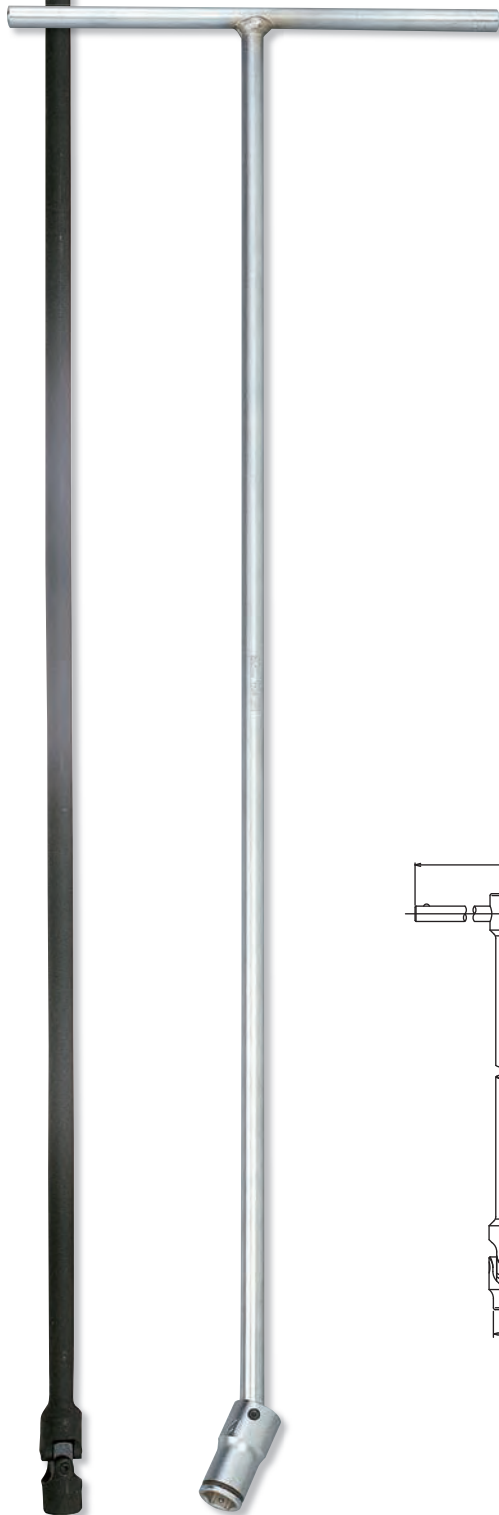

3116M (mm)	D (mm)	H (mm)	L ₁ (mm)	L ₂ (mm)	(g)	(pce.)
10	14.5	8	800	190	796	1
12	17	10.3	800	190	797	1
13	18	11.3	800	190	797	1
14	19.5	11.3	800	190	797	1
15	21	12.8	800	190	799	1
16	22	12.8	800	190	806	1
17	23.6	13.8	800	190	801	1
18	24	13.8	800	190	809	1

124M-600 (mm)	D (mm)	H (mm)	L ₁ (mm)	L ₂ (mm)	(g)	(pce.)
8(2B)	12	5	600	200	332	1
10(2B)	14.5	6	600	200	334	1
12(2B)	16.8	7	600	200	424	1
13(2B)	18	8	600	200	425	1
14(2B)	19.5	8.5	600	200	527	1
17(2B)	23.3	9.5	600	200	538	1

NUT GRIP®

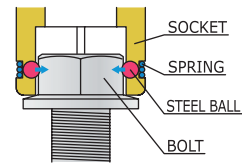

NUT GRIP®

Twin balls at the 6-point opening hold bolt/nut tightly for safe and reliable work.

Die zwei Kugeln in der 6-kant Öffnung unserer NUT GRIP Steckschlüssel halten die Schraube sicher im Steckschlüssel. Dies erlaubt ein Arbeiten auch an schwer zugänglichen Stellen.

Les 2 billes dans l'ouverture du 6-pans de la douille retiennent l'écrou de manière sûre et efficace.

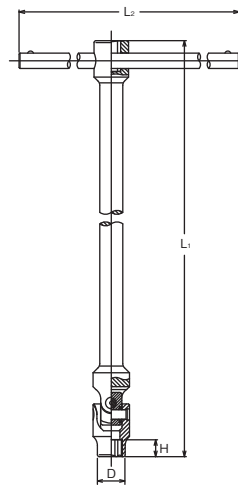



photo: 3116M

157HE  For Inhex Screws
Für Innensechskant-Schrauben
Pour vis à 6-pans creux

157HE (mm)	L ₁ (mm)	L ₂ (mm)	(g)	(pce.)
3	250	180	98	1
4	250	180	121	1
5	250	180	158	1
6	250	180	416	1
8	250	180	422	1
10	300	190	440	1
12	320	210	660	1

157T  For TORX® Screws
Für TORX®-Schrauben
Pour vis TORX®

157T (T)	L ₁ (mm)	L ₂ (mm)	(g)	(pce.)
T25	250	180	95	1
T27	250	180	96	1
T30	250	180	167	1
T40	250	180	168	1
T45	250	180	213	1
T50	250	180	215	1

157S  For Slotted Heads
Für Schlitzschrauben
Pour vis à fente

157S	TxW	L ₁ (mm)	L ₂ (mm)	(g)	(pce.)
6	1.0x6	200	180	84	1
8	1.2x8	250	180	170	1

157PE  For PH Screws
Für Kreuzschlitzschrauben, PH
Pour vis à empreinte PH

157PE (PH)	L ₁ (mm)	L ₂ (mm)	(g)	(pce.)
2	250	180	95	1
3	250	180	170	1

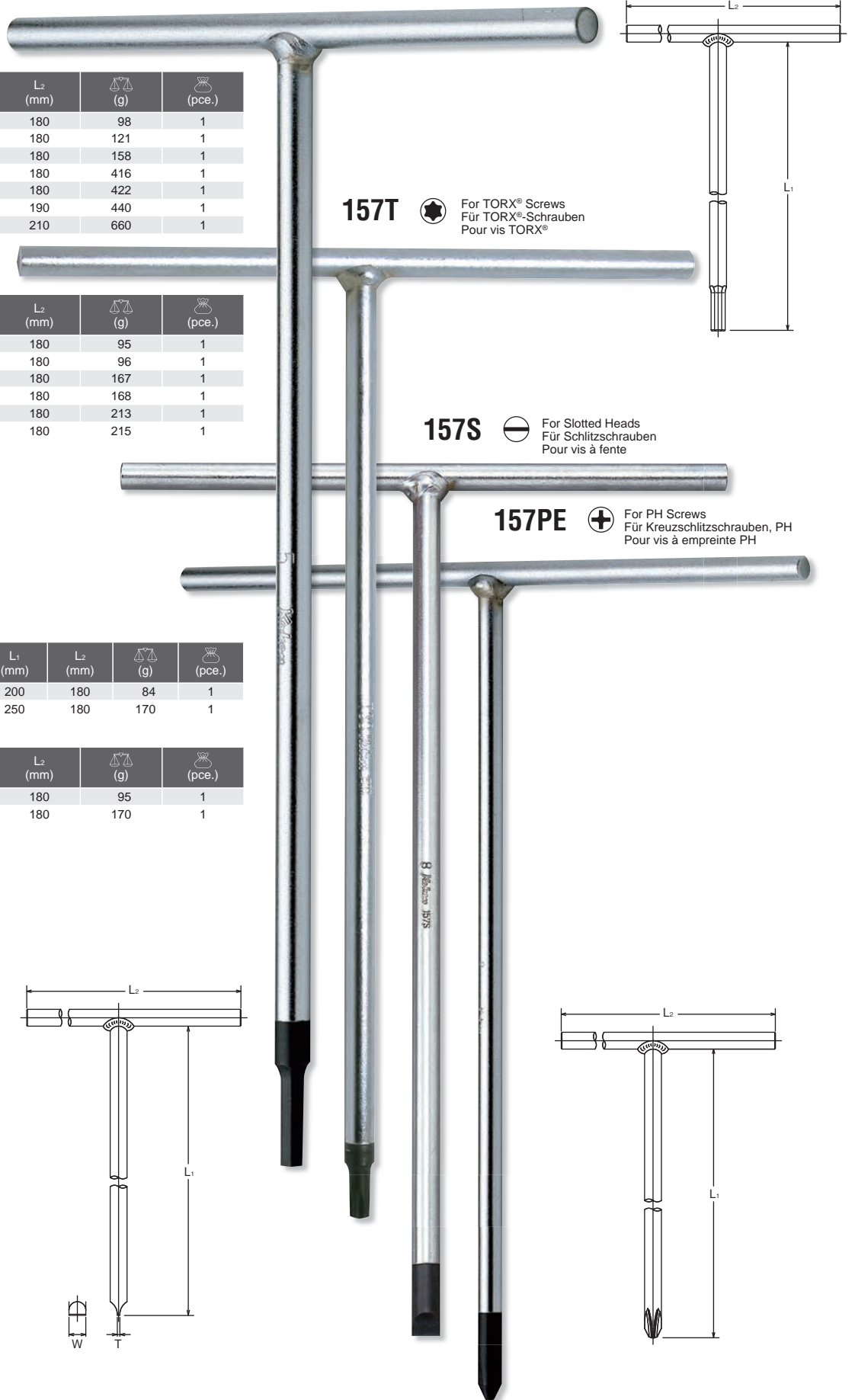

T-Handles
T-Griffe
Poignées en T

Z-SERIES
HAND
TITANIUM
ACCESSORIES
SCREWDRIVERS
IMPACT
SLEEVE-DRIVE
PROTECTOR
INDUSTRIAL
AUTOMOTIVE
MOTORCYCLE
CONSTRUCTION
SPARE PART

2715 T-Handle
T-Griff
Poignée coulissante



3715 T-Handle
T-Griff
Poignée coulissante

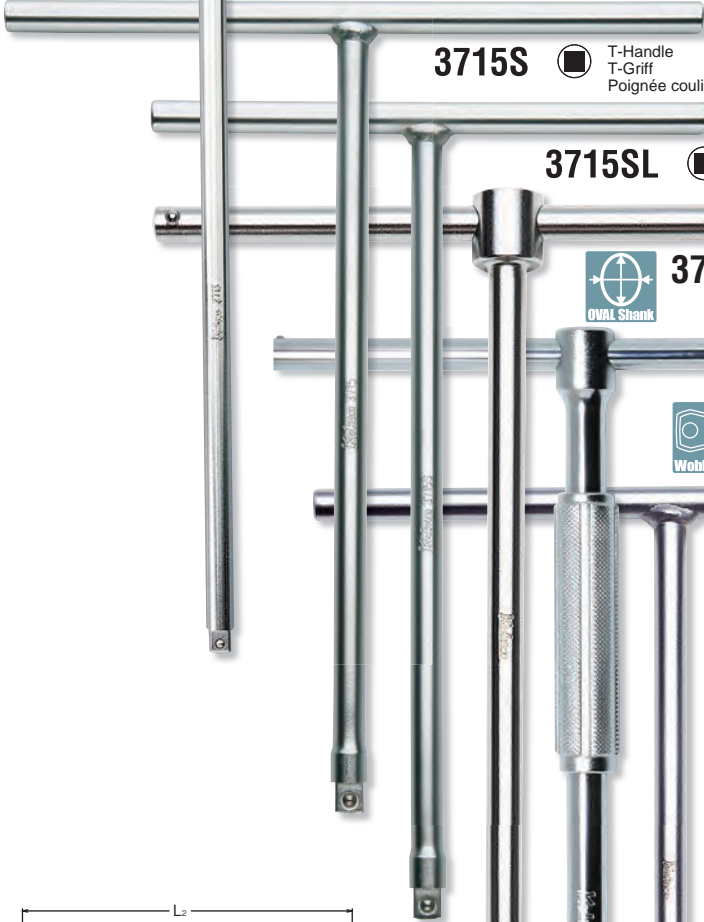

3715S T-Handle
T-Griff
Poignée coulissante

3715SL T-Handle
T-Griff
Poignée coulissante



3715SLK T-handle with freewheel handle
T-Griff mit freilauf Hülse
Poignée en T avec poignée libre



3716 T-Handle
T-Griff
Poignée coulissante



photo: 3715SLK

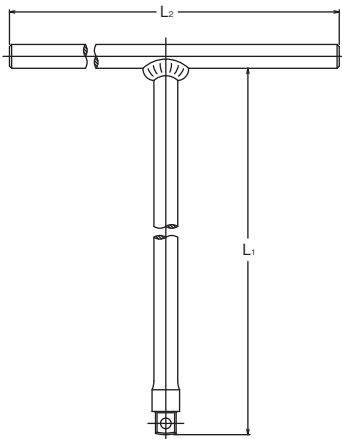

2716WC Dual square drive T-Handle
T-Griff mit 2-fachem Antriebsvierkant
Poignée en T avec double carré d'entraînement



3716WC Dual square drive T-Handle
T-Griff mit 2-fachem Antriebsvierkant
Poignée en T avec double carré d'entraînement



		L ₁ (mm)	L ₂ (mm)	 (g)	 (pcs.)
2715	1/4"	200	120	130	1

		L ₁ (mm)	L ₂ (mm)	 (g)	 (pcs.)
3715	3/8"	268	240	386	1
3715S		268	190	347	1
3715SL		237	200	325	1
3715SLK		236	200	470	1
3716		268	240	379	1

3716
3716 has a reduced square drive and similar function as offset extension bars.

		L ₁ (mm)	L ₂ (mm)	 (g)	 (pcs.)
New 2716WC	1/4"	120	100	87	10
New 3716WC	3/8"	120	100	119	10

4715  T-Handle
T-Griff
Poignée coulissante







4715S  T-Handle
T-Griff
Poignée coulissante

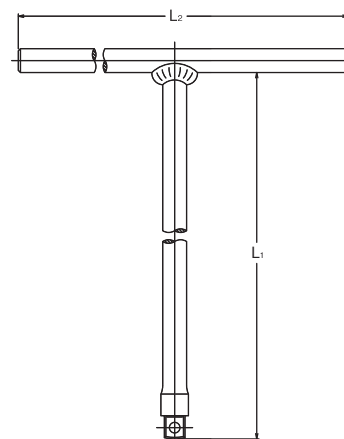

4715SL  T-Handle
T-Griff
Poignée coulissante



		L ₁ (mm)	L ₂ (mm)	 (g)	 (pce.)
4715		267	255	475	1
4715S		267	170	402	1
4715SL		250	250	640	1

4711X  Spinning cross wrench
T-Griff für die Radmuttermontage
Poignée coulissante pour montage des écrous à roue

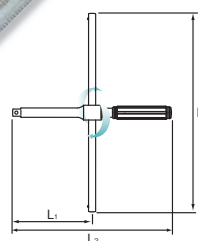
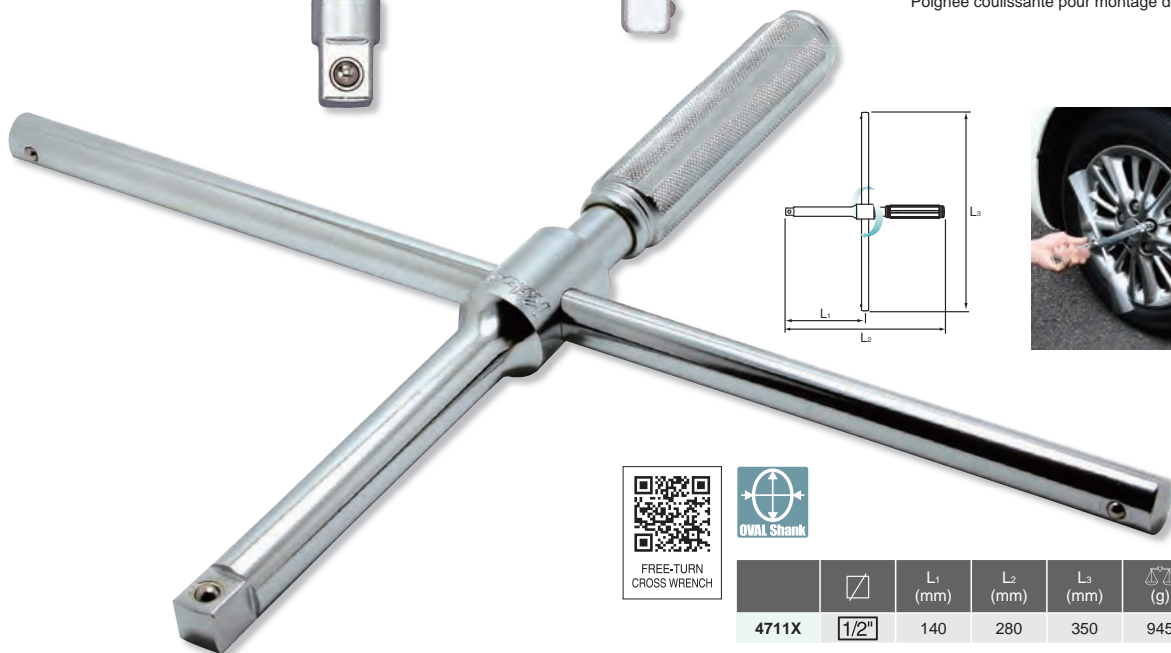

		L ₁ (mm)	L ₂ (mm)	L ₃ (mm)	 (g)	 (pce.)
4711X		140	280	350	945	1

Attack Drivers

Hand-Schlagschrauber

Tournevis à frapper

Z-SERIES
HAND
TITANIUM
ACCESSORIES
SCREWDRIVERS
IMPACT
SLEEVE-DRIVE
PROTECTOR
INDUSTRIAL
AUTOMOTIVE
MOTORCYCLE
CONSTRUCTION
SPARE PART

3112G Attack Driver
Handschlagschrauber
Tournevis à frapper



	□	L (mm)	⚖ (g)	📦 (pce.)
3112G	3/8"	159	810	1



	□	L (mm)	⚖ (g)	📦 (pce.)
4112G	1/2"	163	810	1
4112N		163	730	1

* 4112N Renewal Kits → **4112RK** → P319

4112G Attack Driver
Handschlagschrauber
Tournevis à frapper



	□	L (mm)	⚖ (g)	📦 (pce.)
6112	3/4"	190	1900	1

* Renewal Kits → **6112RK** → P319

4112N Attack Driver
Handschlagschrauber
Tournevis à frapper



Black finished striking head prevents the problem of peeling.
Das geschwärzte Schlagende vermeidet das Abspringen von Chromteilen.
La finition "black finish" de la tête évite l'écaillage dû au chromage.

6112 Attack Driver
Handschlagschrauber
Tournevis à frapper

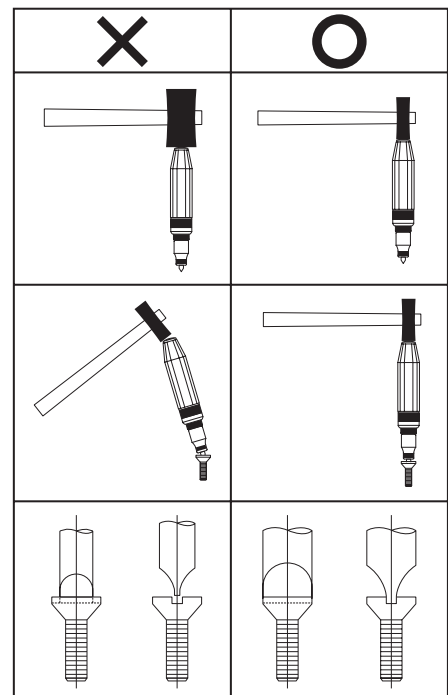

AG318A 6 Pieces Set/△=1,150g

METAL CASE:W220xH82xT60mm

Bits	Accessories
100P.32 PH Bits 2, 3	3112G
100S.32 Slotted Bits 9, 11	3138

AG112A 6 Pieces Set/△=1,150g

METAL CASE:W220xH82xT60mm

Bits	Accessories
100P.32 PH Bits 2, 3	4112G
100S.32 Slotted Bits 9, 11	4138

100P, S Bits →P168

AG112H 18 Pieces Set/△=1,480g

METAL CASE:W220xH82xT60mm

Bits	Accessories
100P.32 PH Bits 2, 3, 4	4112G
100S.32 Slotted Bits 8, 9, 10, 12, 14	4138
100H.32 Hex Bits 5, 6, 8, 10	
100T.32 TORX® Bits T30, T40, T45, T50	

100P, S, H, T Bits →P168

AG112F 25 Pieces Set/△=1,530g

METAL CASE:W220xH82xT60mm

Bits	Accessories
100P.32 PH Bits 2, 3	4112G
100P.32 PZ Bits PZ2, PZ3	4138
100S.32 Slotted Bits 9, 11	
100H.32 Hex Bits 4, 5, 6, 7, 8, 10	
100T.32 TORX® Bits T25, T27, T30, T40, T45, T50	
100X.32 XZN Bits M5, M6, M8, M10, M12	

100P, S, H, T, X Bits →P168-169

AN112A 6 Pieces Set/△=1,070g

METAL CASE:W190xH59xT45mm

Bits	Accessories
100P.32 PH Bits 2, 3	4112N
100S.32 Slotted Bits 9, 11	4138

100P, S Bits →P168

AN112C 8 Pieces Set/△=1,350g

METAL CASE:W215xH80xT47mm

Bits	Accessories
100P.80 PH Bits 1, 2, 3	4112N
100S.80 Slotted Bits 7, 9, 12	4138

100P, S Bits →P168

AG318A Attack Driver Set
Handschlagschrauber-Satz
Jeu de tournevis à frapper



AG112H Attack Driver Set
Handschlagschrauber-Satz
Jeu de tournevis à frapper



AG112F Attack Driver Set
Handschlagschrauber-Satz
Jeu de tournevis à frapper



AN112A Attack Driver Set
Handschlagschrauber-Satz
Jeu de tournevis à frapper



AN112C Attack Driver Set
Handschlagschrauber-Satz
Jeu de tournevis à frapper



108P-25 / -32 / -50  PH Bits
PH Bits
Embout, PH

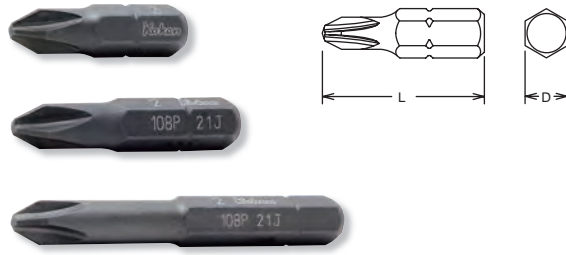

108P-25 (PH)	D (mm)	L (mm)	(g)	(pcs.)
1	6.35	25	5	10
2	6.35	25	5	10
3	6.35	25	6	10

108P-32 (PH)	D (mm)	L (mm)	(g)	(pcs.)
1	6.35	32	7	10
2	6.35	32	7	10
3	6.35	32	8	10

108P-50 (PH)	D (mm)	L (mm)	(g)	(pcs.)
1	6.35	50	10	10
2	6.35	50	11	10
3	6.35	50	11	10

108S-25 / -39  Slotted Bits
Schlitz Bits
Embout, fente

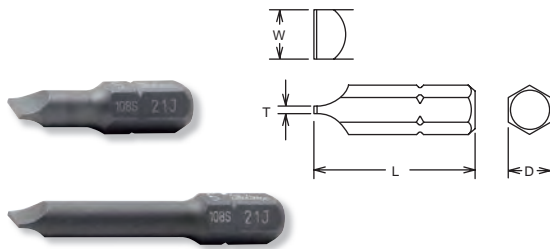

108S-25	TxW (mm)	D (mm)	L (mm)	(g)	(pcs.)
3	0.5x3	6.35	25	3	10
4	0.6x4	6.35	25	3	10
4.5	0.6x4.5	6.35	25	4	10
5	0.8x5	6.35	25	5	10
5.5	0.8x5.5	6.35	25	5	10
6	1.0x6	6.35	25	5	10
8	1.2x8	6.35	25	6	10

108S-39	TxW (mm)	D (mm)	L (mm)	(g)	(pcs.)
3	0.5x3	6.35	39	6	10
4	0.6x4	6.35	39	6	10
4.5	0.6x4.5	6.35	39	6	10
5	0.8x5	6.35	39	7	10
5.5	0.8x5.5	6.35	39	8	10
6	1.0x6	6.35	39	9	10
8	1.2x8	6.35	39	12	10

108H-25  Hex Bits
Sechskant Bits
Embout, 6 pans creux

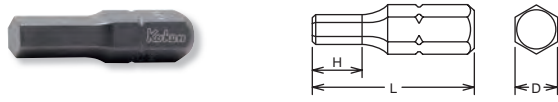

108H-25 (mm)	D (mm)	H (mm)	L (mm)	(g)	(pcs.)
3	6.35	9	25	4	10
4	6.35	9.5	25	5	10
5	6.35	10.5	25	5	10
6	6.35	11.5	25	6	10
7	6.35	-	25	7	10
8	6.35	-	25	8	10
10	6.35	-	25	11	10

108T-25 (T)  TORX® Bits
TORX® Bits
Embout, TORX®

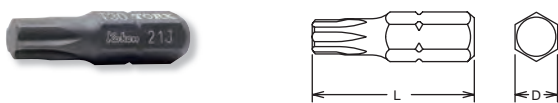

108H-25 (inch)	D (mm)	H (mm)	L (mm)	(g)	(pcs.)
1/8	6.35	9	25	4	10
9/64	6.35	9.5	25	5	10
5/32	6.35	9.5	25	5	10
3/16	6.35	10.5	25	5	10
7/32	6.35	11.5	25	6	10
1/4	6.35	-	25	7	10

108T-25 (TH)  Tamper-Resistant TORX® Bits
Tamper-Resistant TORX® Bits
Embout TORX®, Tamper-Resistant

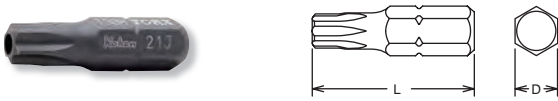

108T-25 (T)	D (mm)	L (mm)	(g)	(pcs.)
T 8	6.35	25	4	10
T10	6.35	25	4	10
T15	6.35	25	4	10
T20	6.35	25	5	10
T25	6.35	25	6	10
T27	6.35	25	6	10
T30	6.35	25	6	10
T40	6.35	25	6	10



Tamper resistant TORX® Bits have less strength due to special design. Make sure to use it correctly.

Die manipulationsicheren TORX®-Bits haben aufgrund ihres speziellen Designs eine geringere Festigkeit. Achten Sie darauf, sie richtig zu verwenden.

Les embouts TORX® à l'abri de manipulation sont moins résistants en raison de leur conception spéciale. Veuillez les utiliser correctement.

108A  Adaptor
Verbindungsstück
Adaptateur



108T-25 (TH)	D (mm)	L (mm)	(g)	(pcs.)
T10H	6.35	25	4	10
T15H	6.35	25	4	10
T20H	6.35	25	5	10
T25H	6.35	25	6	10
T27H	6.35	25	6	10
T30H	6.35	25	6	10
T40H	6.35	25	6	10

108A-25	D (mm)	L (mm)	(g)	(pcs.)
1/4B	6.35	25	10	10

		D ₁ (mm)	D ₂ (mm)	L (mm)	(g)	(pcs.)
2137	1/4"	12	12	22.5	13	10
3137	3/8"	13	16.5	30	30	10
4137	1/2"	13	22	38	53	10

For DIN3126 C6.3 Bits
Für DIN3126 C6.3 Bits
Pour DIN3126 C6.3 Embouts

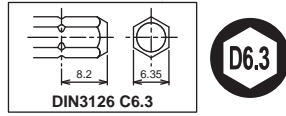

- 2137 Bit Holder
Klingenhalter
Porte-embouts
- 3137
- 4137



		D ₁ (mm)	D ₂ (mm)	L (mm)	(g)	(pcs.)	
12139	1/4"	11	13	25	15	10	*1
13139	3/8"	11	19	30	32	10	*2
14139	1/2"	11	25	35	62	10	*3

*1 Pin/O-Ring=A21/B21
*2 C-Ring=C31,Pin/O-Ring=A31/B31
*3 C-Ring=C41,Pin/O-Ring=A41/B41

→ P268-269

For DIN3126 C6.3 Bits
Für DIN3126 C6.3 Bits
Pour DIN3126 C6.3 Embouts

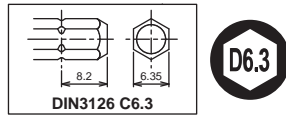

- 12139 Impact Bit Holder
Impact Klingenhalter
Porte embouts Impact
- 13139
- 14139



		D ₁ (mm)	D ₂ (mm)	L (mm)	(g)	(pcs.)	
13142-D6.3	3/8"	16	19	45	60	10	*1
14142-D6.3	1/2"	16	25	55	97	10	*2

*1 C-Ring=C31,Pin/O-Ring=A31/B31
*2 C-Ring=C41,Pin/O-Ring=A41/B41

→ P268-269

For DIN3126 C6.3 Bits
Für DIN3126 C6.3 Bits
Pour DIN3126 C6.3 Embouts

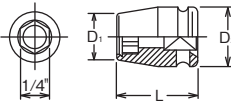
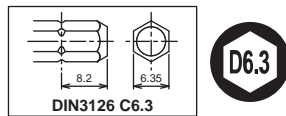

- 13142-D6.3 Impact Bit Holder
Impact Klingenhalter
Porte embouts Impact
- 14142-D6.3

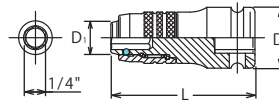

Lock & Quick Release

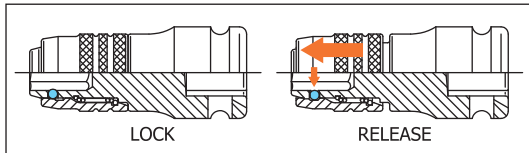

You may not hold the sliding part while moving to avoid heating up by friction and reduction by wear.
Bitte das gleitende Teil während der Bewegung nicht festhalten, um eine Erhitzung durch Reibung und durch Verschleiß zu vermeiden.
Vous ne devez pas tenir la partie coulissante pendant le déplacement afin d'éviter l'échauffement par frottement et la réduction par usure la réduction par l'usure.

	D (mm)	H (mm)	L (mm)	(g)	(pcs.)
2749P-1/4HF	25	12	125	96	1
2774P-1/4HF	25	12	165	133	1

For DIN3126 C6.3 Bits
Für DIN3126 C6.3 Bits
Pour DIN3126 C6.3 Embouts

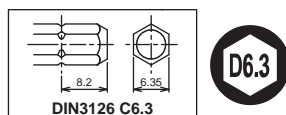

- 2749P-1/4HF Reversible Ratchet, for Bits 1/4"
Knarre, verstellbar, für Bits 1/4"
Cliquet, réversible pour embouts 1/4"



- 2774P-1/4HF Flexible Ratchet, reversible, for Bits 1/4"
Gelenk-Knarre, verstellbar, für Bits 1/4"
Cliquet à tête articulée pour embouts 1/4"

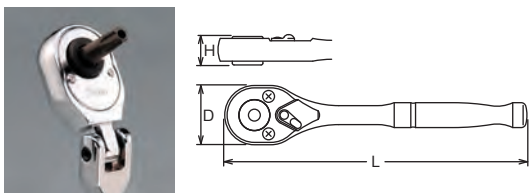

	D (mm)	H (mm)	L (mm)	(g)	(pcs.)
180M-50	11	13.5	50	15	10

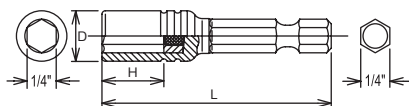

- 180M-50 Bit Holder with Magnet
Klingenhalter mit Magnet
Porte-embouts avec aimant



Z-SERIES
HAND
TITANIUM
ACCESSORIES
SCREWDRIVERS
IMPACT
SLEEVE-DRIVE
PROTECTOR
INDUSTRIAL
AUTOMOTIVE
MOTORCYCLE
CONSTRUCTION
SPARE PART

100P-32 / -80 / -125

PH Bits
PH Bits
Embouts, PH

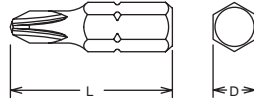

100P-32 (PH)	D (mm)	L (mm)	(g)	(pcs.)
1	8	32	11	10
2	8	32	11	10
3	8	32	12	10
4	8	32	12	10

100P-80 (PH)	D (mm)	L (mm)	(g)	(pcs.)
1	8	80	30	10
2	8	80	30	10
3	8	80	31	10
4	8	80	32	10

100P-125 (PH)	D (mm)	L (mm)	(g)	(pcs.)
2	8	125	48	10
3	8	125	49	10

100P-32 (PZ)

PZ Bits
PZ Bits
Embouts, PZ

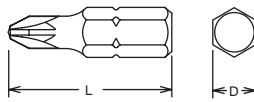

100P-32 (PZ)	D (mm)	L (mm)	(g)	(pcs.)
PZ2	8	32	10	10
PZ3	8	32	11	10

100S-32 / -80

Slotted Bits
Schlitz Bits
Embouts, fente

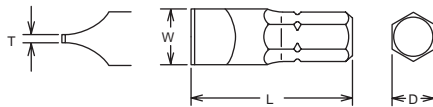

100S-32	TxW (mm)	D (mm)	L (mm)	(g)	(pcs.)
6	1 x 6	8	32	10	10
7	1 x 7	8	32	11	10
8	1.2x 8	8	32	12	10
9	1.6x 9	8	32	12	10
10	1.6x10	8	32	13	10
11	1.6x11	8	32	15	10
12	2 x12	8	32	18	10
14	2 x14	8	32	21	10

100S-80	TxW (mm)	D (mm)	L (mm)	(g)	(pcs.)
6	1 x 6	8	80	29	10
7	1 x 7	8	80	30	10
8	1.2x 8	8	80	31	10
9	1.6x 9	8	80	32	10
10	1.6x10	8	80	33	10
11	1.6x11	8	80	33	10
12	2 x12	8	80	34	10
14	2 x14	8	80	37	10

100H-32

Hex Bits
Sechskant Bits
Embouts, 6 pans creux

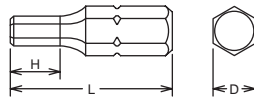

100H-32 (mm)	D (mm)	H (mm)	L (mm)	(g)	(pcs.)
3	8	6	32	11	10
4	8	6	32	11	10
5	8	6	32	12	10
6	8	8	32	12	10
7	8	8	32	13	10
8	8	-	32	13	10
9	8	-	32	16	10
10	8	-	32	16	10
11	8	-	32	20	10
12	8	-	32	23	10
14	8	-	32	29	10

100T-32 (T)

TORX® Bits
TORX® Bits
Embouts, TORX®

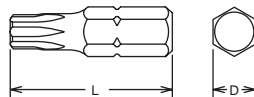

100T-32 (T)	D (mm)	L (mm)	(g)	(pcs.)
T10	8	32	9	10
T15	8	32	9	10
T20	8	32	9	10
T25	8	32	10	10
T27	8	32	10	10
T30	8	32	11	10
T40	8	32	12	10
T45	8	32	12	10
T50	8	32	12	10
T55	8	32	12	10

100T-32 (TH)	D (mm)	L (mm)	(g)	(pcs.)
T10H	8	32	9	10
T15H	8	32	9	10
T20H	8	32	9	10
T25H	8	32	10	10
T27H	8	32	10	10
T30H	8	32	11	10
T40H	8	32	12	10
T45H	8	32	12	10
T50H	8	32	12	10
T55H	8	32	12	10

100X-32	D (mm)	L (mm)	(g)	(pcs.)
M 5	8	32	10	10
M 6	8	32	11	10
M 8	8	32	12	10
M10	8	32	16	10
M12	8	32	19	10

	□	D ₁ (mm)	D ₂ (mm)	L (mm)	(g)	(pcs.)
2138	1/4"	16	16	26	32	10
3138	3/8"	16	18	38	55	10
4138	1/2"	16	22	38	62	10

For DIN3126 C8 Bits
Für DIN3126 C8 Bits
Pour DIN3126 C8 Embouts

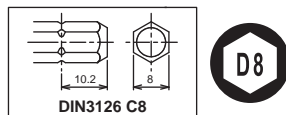

	□	D ₁ (mm)	D ₂ (mm)	L (mm)	(g)	(pcs.)	⚡
12140	1/4"	14	13	25	15	10	*1
13140	3/8"	14	19	30	32	10	*2
14140	1/2"	14	25	35	62	10	*3

*1 Pin/O-Ring=A21/B21
*2 C-Ring=C31,Pin/O-Ring=A31/B31
*3 C-Ring=C41,Pin/O-Ring=A41/B41

→ P268-269

For DIN3126 C8 Bits
Für DIN3126 C8 Bits
Pour DIN3126 C8 Embouts

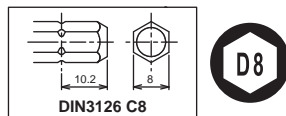

	D (mm)	H (mm)	L (mm)	(g)	(pcs.)
2749P-5/16HF	25	14	125	96	1
2774P-5/16HF	25	14	165	133	1

For DIN3126 C8 Bits
Für DIN3126 C8 Bits
Pour DIN3126 C8 Embouts

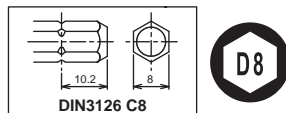

100T-32 (TH)

Tamper-Resistant TORX® Bits
Tamper-Resistant TORX® Bits
Embouts TORX®, Tamper-Resistant

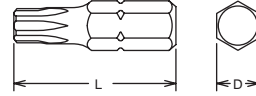

Tamper resistant TORX® Bits have less strength due to special design. Make sure to use it correctly. Die manipulations-sicheren TORX®-Bits haben aufgrund ihres speziellen Designs eine geringere Festigkeit. Achten Sie darauf, sie richtig zu verwenden.

Les embouts TORX® à l'abri de manipulations sont moins résistants en raison de leur conception spéciale. Veuillez les utiliser correctement.

100X-32 (XZN)

XZN Bits
XZN Bits
Embouts, XZN

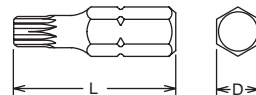

2138 ○ Bit Holder
Klingenhalter
Porte-embouts
3138 ○
4138 ○

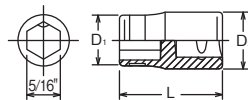

12140 ○ Impact Bit Holder
Impact Klingenhalter
Porte embouts Impact
13140 ○
14140 ○

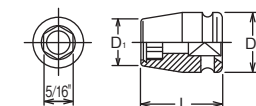

2749P-5/16HF

Reversible Ratchet, for Bits 5/16"
Knarre, verstellbar für Bits 5/16"
Cliquet, réversible pour embouts 5/16"



2774P-5/16HF

Flexible Ratchet, reversible, for Bits 5/16"
Gelenk-Knarre, verstellbar, für Bits 5/16"
Cliquet à tête articulée pour embouts 5/16"

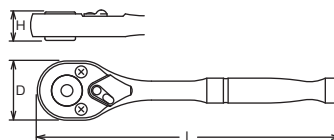

121P-50 / -70 / -100 / -150  PH Bits
PH Bits
Embouts, PH

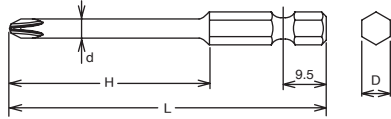

121P-50 (PH)	D (mm)	d (mm)	H (mm)	L (mm)	(g)	(pcs.)
1	6.35	4.5	24	50	12	10
2	6.35	5.5	24	50	12	10
3	6.35	-	24	50	13	10

121P-70 (PH)	D (mm)	d (mm)	H (mm)	L (mm)	(g)	(pcs.)
1	6.35	4.5	44	70	15	10
2	6.35	5.5	44	70	15	10
3	6.35	-	44	70	16	10

121P-100 (PH)	D (mm)	d (mm)	H (mm)	L (mm)	(g)	(pcs.)
1	6.35	4.5	74	100	23	10
2	6.35	5.5	74	100	23	10
3	6.35	-	74	100	24	10

121P-150 (PH)	D (mm)	d (mm)	H (mm)	L (mm)	(g)	(pcs.)
1	6.35	4.5	124	150	30	10
2	6.35	5.5	124	150	35	10
3	6.35	-	124	150	36	10

121H-50 / -70 / -100 / -150  Hex Bits
Sechskant Bits
Embouts, 6 pans creux

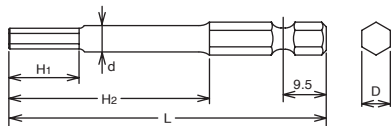

121H-50 (mm)	D (mm)	d (mm)	H ₁ (mm)	H ₂ (mm)	L (mm)	(g)	(pcs.)
2	6.35	3	5	24	50	11	10
2.5	6.35	3	7.5	24	50	12	10
3	6.35	3.5	8.5	24	50	12	10
4	6.35	4.5	10	24	50	12	10
5	6.35	5.6	10	24	50	13	10
6	6.35	-	10	-	50	14	10

121H-70 (mm)	D (mm)	d (mm)	H ₁ (mm)	H ₂ (mm)	L (mm)	(g)	(pcs.)
2	6.35	3	5	44	70	13	10
2.5	6.35	3	7.5	44	70	15	10
3	6.35	3.5	8.5	44	70	15	10
4	6.35	4.5	10	44	70	15	10
5	6.35	5.6	10	44	70	16	10
6	6.35	-	10	-	70	18	10

121H-100 (mm)	D (mm)	d (mm)	H ₁ (mm)	H ₂ (mm)	L (mm)	(g)	(pcs.)
2	6.35	3	5	74	100	22	10
2.5	6.35	3	7.5	74	100	23	10
3	6.35	3.5	8.5	74	100	23	10
4	6.35	4.5	10	74	100	23	10
5	6.35	5.6	10	74	100	24	10
6	6.35	-	10	-	100	26	10

121H-150 (mm)	D (mm)	d (mm)	H ₁ (mm)	H ₂ (mm)	L (mm)	(g)	(pcs.)
2	6.35	3.5	5	124	150	35	10
2.5	6.35	3.5	7.5	124	150	35	10
3	6.35	3.5	8.5	124	150	37	10
4	6.35	4.5	10	124	150	37	10
5	6.35	5.6	10	124	150	38	10
6	6.35	-	10	-	150	39	10

121T-50 / -70 / -100 / -150 (T)  TORX® Bits
TORX® Bits
Embouts, TORX®

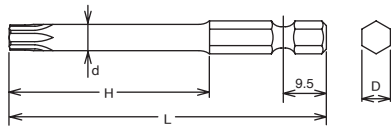

121T-50 (T)	D (mm)	d (mm)	H (mm)	L (mm)	(g)	(pcs.)
T10	6.35	3	24	50	12	10
T15	6.35	3.5	24	50	12	10
T20	6.35	4.1	24	50	12	10
T25	6.35	4.6	24	50	12	10
T27	6.35	5.2	24	50	13	10
T30	6.35	5.7	24	50	13	10
T40	6.35	-	-	50	14	10

121T-70 (T)	D (mm)	d (mm)	H (mm)	L (mm)	(g)	(pcs.)
T10	6.35	3.5	44	70	16	10
T15	6.35	3.5	44	70	16	10
T20	6.35	4.1	44	70	16	10
T25	6.35	4.6	44	70	16	10
T27	6.35	5.2	44	70	17	10
T30	6.35	5.7	44	70	17	10
T40	6.35	-	-	70	18	10

121T-100 (T)	D (mm)	d (mm)	H (mm)	L (mm)	(g)	(pcs.)
T10	6.35	3.5	74	100	24	10
T15	6.35	3.5	74	100	24	10
T20	6.35	4.1	74	100	24	10
T25	6.35	4.6	74	100	24	10
T27	6.35	5.2	74	100	24	10
T30	6.35	5.7	74	100	25	10
T40	6.35	-	-	100	26	10

121T-150 (T)	D (mm)	d (mm)	H (mm)	L (mm)	(g)	(pcs.)
T10	6.35	3.5	124	150	35	10
T15	6.35	3.5	124	150	37	10
T20	6.35	4.1	124	150	37	10
T25	6.35	4.6	124	150	37	10
T27	6.35	5.2	124	150	37	10
T30	6.35	5.7	124	150	38	10
T40	6.35	-	-	150	39	10

121T-70 (TH)	D (mm)	d (mm)	H (mm)	L (mm)	(g)	(pcs.)
T15H	6.35	3.5	44	70	15	10
T20H	6.35	4.1	44	70	16	10
T25H	6.35	4.6	44	70	16	10
T27H	6.35	5.2	44	70	17	10
T30H	6.35	5.7	44	70	17	10
T40H	6.35	-	-	70	18	10

121T-100 (TH)	D (mm)	d (mm)	H (mm)	L (mm)	(g)	(pcs.)
T15H	6.35	3.5	74	100	22	10
T20H	6.35	4.1	74	100	24	10
T25H	6.35	4.6	74	100	24	10
T27H	6.35	5.2	74	100	24	10
T30H	6.35	5.7	74	100	25	10
T40H	6.35	-	-	100	26	10

121T-50 (IP)	D (mm)	d (mm)	H (mm)	L (mm)	(g)	(pcs.)
20IP	6.35	4.1	24	50	12	10
25IP	6.35	4.6	24	50	12	10
27IP	6.35	5.2	24	50	13	10
30IP	6.35	5.7	24	50	13	10
40IP	6.35	-	-	50	14	10

121T-70 (IP)	D (mm)	d (mm)	H (mm)	L (mm)	(g)	(pcs.)
20IP	6.35	4.1	44	70	16	10
25IP	6.35	4.6	44	70	16	10
27IP	6.35	5.2	44	70	17	10
30IP	6.35	5.7	44	70	17	10
40IP	6.35	-	-	70	18	10

	Pin/O-Ring	D ₁ (mm)	D ₂ (mm)	L (mm)	(g)	(pcs.)	
12137E	1/4"	12	13	36	22	10	*1
13137E	3/8"	12	19	40	40	10	*2
14137E	1/2"	12	25	48	70	10	*3

*1 Pin/O-Ring=A21/B21
 *2 C-Ring=C31, Pin/O-Ring=A31/B31
 *3 C-Ring=C41, Pin/O-Ring=A41/B41
 12137E, 13137E and 14147E can be used with various 1/4" bits, DIN 3126-C6.3, DIN 3126-E6.3 and Double ended type.
 Die neuen Bithalter können für alle 1/4" Bits DIN 3126-C6.3, DIN 3126-E6.3 und für doppelseitige Bits verwendet werden.
 Ces nouveaux porte embouts peuvent être utilisés avec tous les embouts 1/4" DIN 3126 E-6.3 et DIN 3126 C6.3

	Pin/O-Ring	D ₁ (mm)	D ₂ (mm)	L (mm)	(g)	(pcs.)	
12142-F6.3	1/4"	16.5	13	40	22	10	*1
13142-F6.3	3/8"	16.5	19	45	60	10	*2
14142-F6.3	1/2"	16.5	25	55	100	10	*3

*1 Pin/O-Ring=A21/B21
 *2 C-Ring=C31, Pin/O-Ring=A31/B31
 *3 C-Ring=C41, Pin/O-Ring=A41/B41

For DIN3126 E6.3 Bits
 Für DIN3126 E6.3 Bits
 Pour DIN3126 E6.3 Embouts

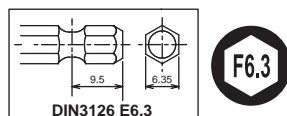

Lock & Quick Release

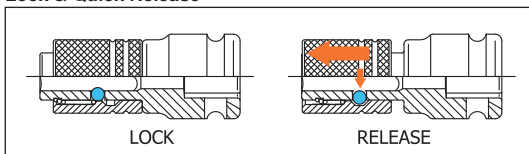

⚠ You may not hold the sliding part while moving to avoid heating up by friction and reduction by wear.
 Bitte das gleitende Teil während der Bewegung nicht festhalten, um eine Erhitzung durch Reibung und durch Verschleiß zu vermeiden.
 Vous ne devez pas tenir la partie coulissante pendant le déplacement afin d'éviter l'échauffement par frottement et la réduction par usure la réduction par l'usure.

121T-70 / -100 (TH) Tamper-Resistant TORX® Bits Tamper-Resistant TORX® Bits Embouts TORX®, Tamper-Resistant

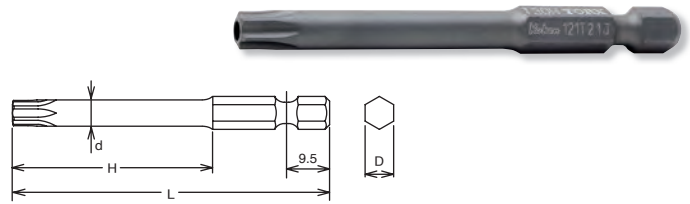

⚠ Tamper resistant TORX® Bits have less strength due to special design. Make sure to use it correctly.
 Die manipulationsicheren TORX®-Bits haben aufgrund ihres speziellen Designs eine geringere Festigkeit. Achten Sie darauf, sie richtig zu verwenden.
 Les embouts TORX® à l'abri de manipulations sont moins résistants en raison de leur conception spéciale. Veuillez les utiliser correctement.

121T-50 / -70 (IP) TORXPLUS® Bits TORXPLUS® Bits Embouts TORXPLUS®

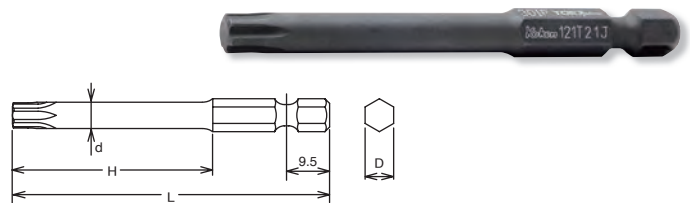

12137E Impact Bit Holder 13137E Impact Klingenhälter 14137E Porte embouts Impact

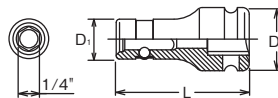

12142-F6.3 Impact Bit Holder (Quick Release) 13142-F6.3 Impact Klingenhälter (Quick Release) 14142-F6.3 Porte embouts Impact (Quick Release)

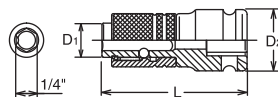

123PT-75 / -100

⊕ Double ended Torsion Bits, PH
Doppelseitige Torsionsbits, PH
Emboutis torsion double face, PH

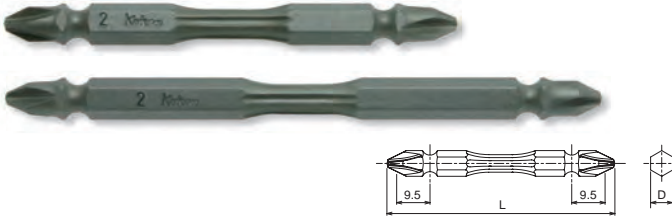

123PN-75 / -100

⊕ Double ended Bits, PH
Doppelseitige bits, PH
Emboutis double face, PH

123PG-75 / -100

⊕ Magnetic type
Magnétisch
Type magnétique

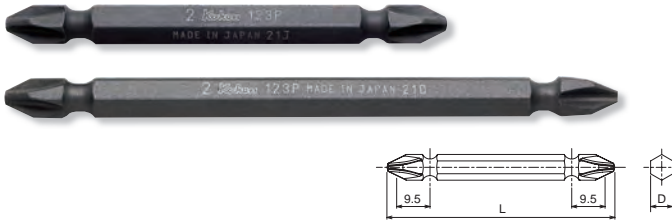

165LM

ⓂG Slide Socket with Magnet
Gleitsteckschlüssel mit Magnet
Clé à douille coulissante avec aimant



Nut Setter

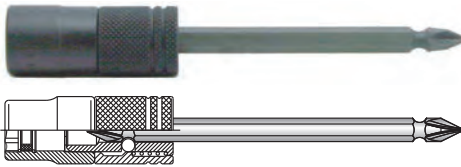

Phillips Bit

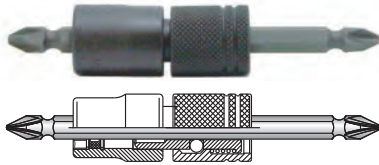

165BM

ⓂG Double-sided socket with side magnets
Doppelseitiger Schiebsteckschlüssel mit Seitenmagneten
Clé à douille double face, coulissante avec aimants latéraux

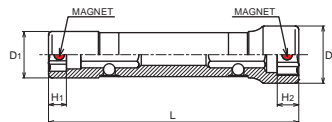

123PT (PH)	D (mm)	L (mm)	(g)	(pcs.)
2	6.35	75	18	10
2	6.35	100	24	10

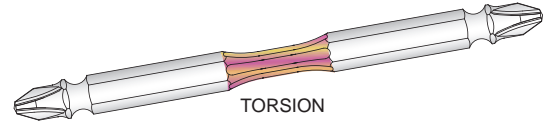

TORSION

123PN-75 123PG-75 (PH)	D (mm)	L (mm)	(g)	(pcs.)
1	6.35	75	16	10
2	6.35	75	16	10
3	6.35	75	17	10

123PN-100 123PG-100 (PH)	D (mm)	L (mm)	(g)	(pcs.)
1	6.35	100	23	10
2	6.35	100	23	10
3	6.35	100	24	10

165LM-45 (mm)	D (mm)	H (mm)	L (mm)	(g)	(pcs.)
8	13.5	3.5	45	55	10
10	16	4.2	45	58	10
12	18.5	5.6	45	65	10
13	20	6	45	68	10
14	21	6.4	45	70	10

Slide the socket by pulling holder, and pull back the socket to lock on the bit groove. Ring magnet holds a bolt or nut for easy work.

Schieben Sie den Gleitsteckschlüssel durch Ziehen an der Hülse des Halters. Ziehen Sie das Werkzeug soweit zurück bis es sich in der Nut des Bits verriegelt. Zur Arbeitserleichterung hält der Ringmagnet die Schraube bzw. die Mutter.

Poussez la clé à douille coulissante en tirant sur le support. Tirez l'outil vers l'arrière jusqu'à ce qu'il s'enclenche dans rainure de la mèche. L'aimant maintient la vis ou l'écrou pour faciliter le travail.

⚠ You may not hold the sliding part while moving to avoid heating up by friction and reduction by wear.

Sie dürfen das Gleiteil nicht während der Bewegung halten, um Erwärmung durch Reibung und unnötigen Verschleiß zu vermeiden.

Ne pas tenir la partie coulissante pendant le mouvement pour éviter l'échauffement du au frottement et à l'usure inutile.

⚠ Please handle with care. The magnet could be broken with any impacts.

Der Magnet kann durch Stöße beschädigt werden. Bitte gehen Sie vorsichtig vor.

L'aimant peut être endommagé par des chocs importants. Veuillez procéder avec précaution.

165BM-70 (mm)	D ₁ (mm)	D ₂ (mm)	H ₁ (mm)	H ₂ (mm)	L (mm)	(g)	(pcs.)
8x10	13	16	5	6	70	55	10

165BM-80 (mm)	D ₁ (mm)	D ₂ (mm)	H ₁ (mm)	H ₂ (mm)	L (mm)	(g)	(pcs.)
10x12	16	19.1	6	8	80	80	10
10x13	16	20.5	8	8	80	80	10

165BM-100 (mm)	D ₁ (mm)	D ₂ (mm)	H ₁ (mm)	H ₂ (mm)	L (mm)	(g)	(pcs.)
10x12	16	19.1	8	8	100	95	10
10x14	16	21.5	8	10	100	105	10
12x14	19.1	21.5	8	10	100	130	10

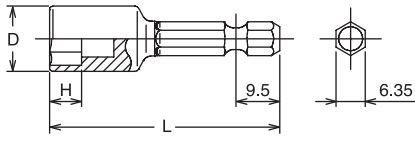

113-50 (mm)	D (mm)	H (mm)	L (mm)	(g)	(pcs.)
5.5	9	4	50	15	10
6	10	5	50	17	10
7	11	5	50	19	10
8	12	6	50	20	10
10	14.2	7	50	31	10
11	16	8	50	28	10
12	17	8	50	39	10
13	18	8	50	42	10
14	19	9	50	46	10

113-50

Nut Setters
Steckschlüssel Klingen
Embouts pour écrous



113-50 (inch)	D (mm)	H (mm)	L (mm)	(g)	(pcs.)
1/4	10	5	50	17	10
5/16	12	6	50	20	10
3/8	14.2	7	50	31	10
1/2	18	8	50	42	10

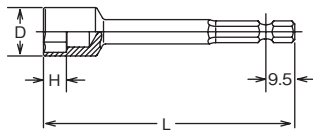

113-75 / -100 / -150 / -200 / -250

Nut Setters
Steckschlüssel Klingen
Embouts pour écrous



113-75 (mm)	D (mm)	H (mm)	L (mm)	(g)	(pcs.)
7	11.5	5	75	31	10
8	12.7	6	75	32	10
10	14.5	7	75	35	10
12	17	8	75	42	10
13	18	8	75	41	10
14	19	9	75	43	10

113-100 (mm)	D (mm)	H (mm)	L (mm)	(g)	(pcs.)
7	11.5	5	100	40	10
8	12.7	6	100	41	10
10	14.5	7	100	45	10
12	17	8	100	52	10
13	18	8	100	51	10
14	19	9	100	53	10

113-150 (mm)	D (mm)	H (mm)	L (mm)	(g)	(pcs.)
7	11.5	5	150	59	10
8	12.7	6	150	60	10
10	14.5	7	150	64	10
12	17	8	150	70	10
13	18	8	150	76	10
14	19	9	150	78	10

113-200 (mm)	D (mm)	H (mm)	L (mm)	(g)	(pcs.)
7	11.5	5	200	78	10
8	12.7	6	200	79	10
10	14.5	7	200	83	10
12	17	8	200	91	10
13	18	8	200	93	10
14	19	9	200	95	10

113-250 (mm)	D (mm)	H (mm)	L (mm)	(g)	(pcs.)
7	11.5	5	250	99	10
8	12.7	6	250	100	10
10	14.5	7	250	105	10
12	17	8	250	113	10
13	18	8	250	114	10
14	19	9	250	119	10

113-50 (E)	D (mm)	H (mm)	L (mm)	(g)	(pcs.)
E 4	6.1	4.5	50	12	10
E 5	7.5	4.5	50	15	10
E 6	8.3	5.0	50	17	10
E 7	8.8	5.8	50	18	10
E 8	10.1	6.6	50	19	10
E10	12	7.4	50	20	10

113-50 (E)

Nut Setters, TORX®
Steckschlüssel Klingen, TORX®
Embouts pour écrous, TORX®

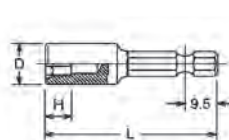

113-50 (mm)	D (mm)	H (mm)	L (mm)	(g)	(pcs.)
7(2B)	11	5	50	20	10
8(2B)	12	6	50	21	10
10(2B)	14.2	7	50	26	10
12(2B)	16	8	50	28	10
13(2B)	18	8	50	31	10



113-50 (2B)

Nut Setters, with 2 Balls
Steckschlüssel Klingen, mit 2-facher Kugelhalterung
Douilles à billes de retenue
Nut Grip®

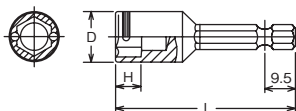

113-50 (inch)	D (mm)	H (mm)	L (mm)	(g)	(pcs.)
3/8(2B)	14.2	7	50	26	10

115-50



Nut Setters with Magnet
Steckschlüssel Klingen mit Magnet
Embouts avec aimant pour écrous

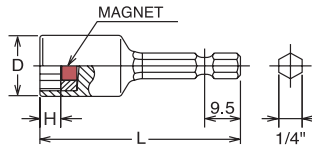

115-50 (mm)	D (mm)	H (mm)	L (mm)	(g)	(pcs.)
5.5	9	2.1	50	15	10
6	10	2.4	50	17	10
7	11	2.8	50	19	10
8	12	3.5	50	20	10
10	14.2	4.2	50	29	10
11	16	4.9	50	35	10
12	17	5.6	50	40	10
13	18	6	50	50	10
14	19	6.4	50	60	10

115-50 (inch)	D (mm)	H (mm)	L (mm)	(g)	(pcs.)
1/4	10	2.4	50	17	10
5/16	12	3.5	50	20	10
3/8	14.2	4.2	50	29	10
1/2	18	6	50	50	10

PK115/7

Nut Setters with Magnet, 7 pcs set in plastic case
Steckschlüsselklingen mit Magnet, 7teiliger Satz in Kunststoffkassette
Lames de clé à douille avec aimant, jeu de 7 pièces en cassette plastique



PK115/7	7 Pieces Set/310g
PLASTIC CASE:W120xH115xT40mm	
Nut Setters	
MG 115-50 Nut Setter with Magnet	
1/4, 3/8, 7, 8, 10, 12, 13	

115-75 / -100 / -150 / -200 / -250



Nut Setters with Magnet
Steckschlüssel Klingen mit Magnet
Embouts avec aimant pour écrous

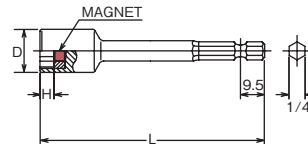

115-75 (mm)	D (mm)	H (mm)	L (mm)	(g)	(pcs.)
7	11.5	2.8	75	32	10
8	12.7	3.5	75	33	10
10	14.5	4.2	75	38	10
12	17	5.6	75	46	10
13	18	6	75	49	10
14	19	6.4	75	52	10

115-150 (mm)	D (mm)	H (mm)	L (mm)	(g)	(pcs.)
7	11.5	2.8	150	60	10
8	12.7	3.5	150	61	10
10	14.5	4.2	150	68	10
12	17	5.6	150	77	10
13	18	6	150	82	10
14	19	6.4	150	85	10

115-250 (mm)	D (mm)	H (mm)	L (mm)	(g)	(pcs.)
7	11.5	2.8	250	101	10
8	12.7	3.5	250	103	10
10	14.5	4.2	250	110	10
12	17	5.6	250	118	10
13	18	6	250	122	10
14	19	6.4	250	124	10

115-100 (mm)	D (mm)	H (mm)	L (mm)	(g)	(pcs.)
7	11.5	2.8	100	41	10
8	12.7	3.5	100	42	10
10	14.5	4.2	100	50	10
12	17	5.6	100	58	10
13	18	6	100	62	10
14	19	6.4	100	65	10

115-200 (mm)	D (mm)	H (mm)	L (mm)	(g)	(pcs.)
7	11.5	2.8	200	79	10
8	12.7	3.5	200	80	10
10	14.5	4.2	200	88	10
12	17	5.6	200	97	10
13	18	6	200	102	10
14	19	6.4	200	105	10

113UN-100 (mm)	D (mm)	H (mm)	L (mm)	(g)	(pcs.)
8	13	7	100	50	10
10	15	8	100	53	10
12	17	10	100	56	10
13	18	10	100	65	10
14	19.2	10	100	67	10

113UN-150 (mm)	D (mm)	H (mm)	L (mm)	(g)	(pcs.)
8	13	7	150	65	10
10	15	8	150	70	10
12	17	10	150	77	10
13	18	10	150	92	10
14	19.2	10	150	92	10

113UN-200 (mm)	D (mm)	H (mm)	L (mm)	(g)	(pcs.)
8	13	7	200	75	10
10	15	8	200	87	10
12	17	10	200	98	10
13	18	10	200	116	10
14	19.2	10	200	116	10

113UN-100 / -150 / -200

6-point Universal Joint Nut Setters
6-kant Steckschlüsselklingen mit Gelenk
Douilles 6-pans articulées à embout



115G-75 / -100 / -150 / -200 / -250 / -300



Nut Setters with sliding Magnet
Steckschlüssel Klingen mit versenkbarem Magnet
Embout avec aimant, glissant pour écrous



115G-75 (mm)	D (mm)	H ₁ (mm)	H ₂ (mm)	L (mm)	(g)	(pcs.)
7	11.5	3.5	26	75	34	10
8	12.7	4	26	75	41	10
10	14.5	4.5	26	75	48	10
12	17	6	26	75	65	10
13	18	6.5	25	75	70	10
14	19	7	24	75	73	10

115G-100 (mm)	D (mm)	H ₁ (mm)	H ₂ (mm)	L (mm)	(g)	(pcs.)
7	11.5	3.5	26	100	51	10
8	12.7	4	26	100	51	10
10	14.5	4.5	26	100	57	10
12	17	6	26	100	77	10
13	18	6.5	25	100	80	10
14	19	7	24	100	82	10

115G-150 (mm)	D (mm)	H ₁ (mm)	H ₂ (mm)	L (mm)	(g)	(pcs.)
7	11.5	3.5	26	150	67	10
8	12.7	4	26	150	70	10
10	14.5	4.5	26	150	77	10
12	17	6	26	150	95	10
13	18	6.5	25	150	100	10
14	19	7	24	150	105	10

115G-200 (mm)	D (mm)	H ₁ (mm)	H ₂ (mm)	L (mm)	(g)	(pcs.)
7	11.5	3.5	26	200	86	10
8	12.7	4	26	200	89	10
10	14.5	4.5	26	200	96	10
12	17	6	26	200	119	10
13	18	6.5	25	200	125	10
14	19	7	24	200	128	10

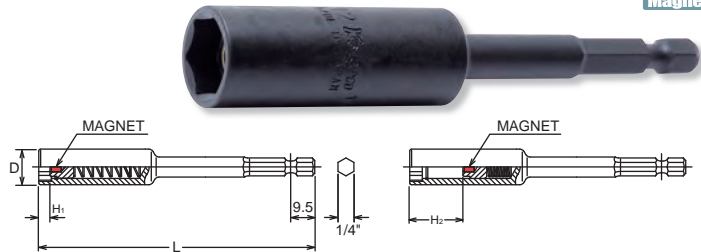

115G-250 (mm)	D (mm)	H ₁ (mm)	H ₂ (mm)	L (mm)	(g)	(pcs.)
8	12.7	4	26	250	110	10
10	14.5	4.5	26	250	120	10
12	17	6	26	250	130	10
13	18	6.5	25	250	150	10

115G-300 (mm)	D (mm)	H ₁ (mm)	H ₂ (mm)	L (mm)	(g)	(pcs.)
10	14.5	4.5	26	300	140	10
12	17	6	26	300	155	10

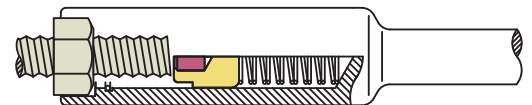

Sliding magnet system provides bolt clearance and magnetic function at the same time. The item 115G is mainly designed for assembly line work.

Die Steckschlüsselklinge mit versenkbarem Magnet bietet die Funktion eines Haltemagneten und genügend Freiraum für überstehende Bolzen. Dieses Werkzeug eignet sich vor allem für Montagearbeiten.

L'embout avec aimant glissant offre une fonction d'aimant et laisse assez d'espace pour des goujons surmontés. L'objet 115G a été conçu spécialement pour le travail d'assemblage.

119 (mm)	D (mm)	H (mm)	L (mm)	(g)	(pcs.)
5.5	9	2.1	50	17	10
6	10	2.4	50	20	10
7	11	2.8	50	22	10
8	12	3.5	50	23	10
10	14.2	4.2	50	30	10
12	17	5.6	50	42	10
13	18	6	50	52	10

119 (inch)	D (mm)	H (mm)	L (mm)	(g)	(pcs.)
1/4	10	1.8	50	20	10
5/16	12	3.5	50	23	10
3/8	14.2	4.2	50	30	10

119



Nut Setters with Magnet
Steckschlüssel Klingen mit Magnet
Embout avec aimant pour écrous

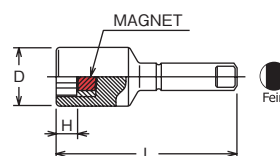

183H-35 / -75 / -150

Hex Bits
Sechskant Bits
Embout, 6 pans creux

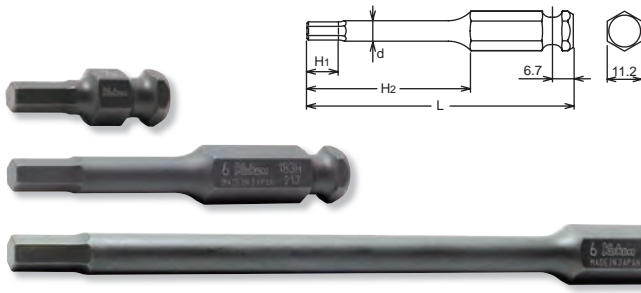

183H-35 (mm)	H ₁ (mm)	H ₂ (mm)	L (mm)	(g)	(pcs.)
3	6	18	35	15	10
4	8	18	35	15	10
5	10	18	35	15	10
6	12	18	35	18	10
7	12	18	35	19	10
8	12	18	35	20	10
9	14.8	18	35	23	10
10	15.6	18	35	26	10
11	17.1	18	35	28	10
12	-	18	35	30	10
14	-	18	35	35	10
16	-	18	35	47	10
17	-	18	35	50	10
18	-	18	35	53	10
19	-	18	35	56	10

183H-35 (inch)	H ₁ (mm)	H ₂ (mm)	L (mm)	(g)	(pcs.)
3/16	10	18	35	15	10
7/32	12	18	35	16	10
1/4	12	18	35	18	10
5/16	12	18	35	20	10
3/8	15.2	18	35	26	10
7/16	-	18	35	28	10
1/2	-	18	35	38	10

183H-75 (mm)	H ₁ (mm)	H ₂ (mm)	L (mm)	d (mm)	(g)	(pcs.)
3	8	42.5	75	6	34	10
4	8	42.5	75	6	35	10
5	10	42.5	75	6.5	36	10
6	12	42.5	75	7.5	39	10
7	12	42.5	75	8.5	44	10
8	12	42.5	75	9.5	47	10
10	15.5	42.5	75	-	57	10
11	15.5	42.5	75	-	60	10
12	-	42.5	75	-	65	10
14	-	42.5	75	-	79	10

183H-150 (mm)	H ₁ (mm)	H ₂ (mm)	L (mm)	d (mm)	(g)	(pcs.)
4	8	117.5	150	6	51	10
5	10	117.5	150	6.5	55	10
6	12	117.5	150	7.5	65	10
8	12	117.5	150	9.5	87	10
10	15.5	117.5	150	-	118	10
12	-	117.5	150	-	136	10

183H-75B / -150B

Ball-point Hex Bits
Sechskant Bits mit Kugelkopf
Embout hexagonal à tête sphérique

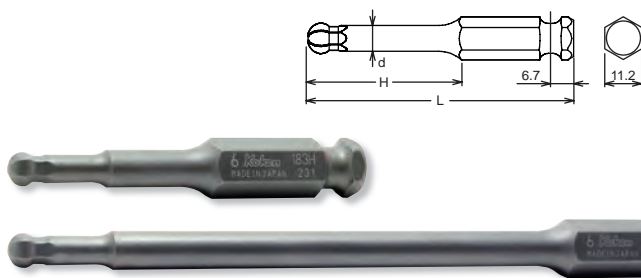

183H-75B (mm)	H (mm)	L (mm)	d (mm)	(g)	(pcs.)
6B	42.5	75	5.7	39	10
8B	42.5	75	7.7	44	10
10B	42.5	75	9.7	49	10
12B	42.5	75	11.7	72	10

183H-150B (mm)	H (mm)	L (mm)	d (mm)	(g)	(pcs.)
6B	117.5	150	5.7	65	10
8B	117.5	150	7.7	71	10
10B	117.5	150	9.7	92	10
12B	117.5	150	11.7	135	10

183T-35 / -75 / -150 (T)

TORX® Bits
TORX® Bits
Embout, TORX®

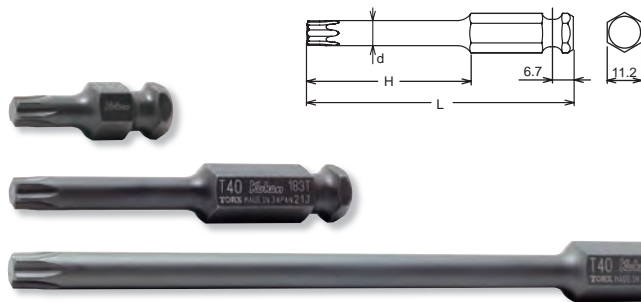

183T-35 (T)	H (mm)	L (mm)	(g)	(pcs.)
T25	18	35	18	10
T30	18	35	18	10
T40	18	35	20	10
T45	18	35	22	10
T50	18	35	26	10
T55	18	35	30	10
T60	18	35	38	10

183T-75 (T)	H (mm)	L (mm)	d (mm)	(g)	(pcs.)
T25	42.5	75	6	33	10
T27	42.5	75	6	33	10
T30	42.5	75	6	35	10
T40	42.5	75	6.9	37	10
T45	42.5	75	8	41	10
T50	42.5	75	9	45	10
T55	42.5	75	11.4	55	10
T60	42.5	75	13.5	67	10

183T-150 (T)	H (mm)	L (mm)	d (mm)	(g)	(pcs.)
T30	117.5	150	6	50	10
T40	117.5	150	6.9	58	10
T45	117.5	150	8	70	10
T50	117.5	150	9	82	10
T55	117.5	150	11.4	113	10
T60	117.5	150	13.5	148	10

⚠ The items with ⚠ have larger output sizes than 7/16" Input drive.
Due to this design the maximum output torque rating is less than standard.

Die mit ⚠ gekennzeichneten Artikel haben größere Abtriebsgrößen als der 7/16" Antrieb.
Aufgrund dieser Konstruktion ist das maximale Abtriebsdrehmoment geringer als der Standardwert.

Les articles marqués d'un ⚠ ont des tailles de sortie plus importantes que l'entraînement d'entrée 7/16".
En raison de cette conception, le couple de sortie maximum est inférieur au couple standard.

TORX® is a registered trademark of CAMCAR Innovations®.
TORX® ist ein registriertes Markenzeichen der Firma CAMCAR Innovations®.
TORX® est une marque déposée de CAMCAR Innovations®.

183T-35 (IP)	H (mm)	L (mm)	(g)	(pcs.)
30IP	18	35	18	10
40IP	18	35	20	10
45IP	18	35	22	10
50IP	18	35	26	10
55IP	18	35	30	10
60IP	18	35	38	10

183T-75 (IP)	H (mm)	L (mm)	d (mm)	(g)	(pcs.)
30IP	42.5	75	6	35	10
40IP	42.5	75	6.8	37	10
45IP	42.5	75	8	41	10
50IP	42.5	75	9	45	10
55IP	42.5	75	11.4	56	10
60IP	42.5	75	13.5	67	10

183X-35 (XZN)	H (mm)	L (mm)	(g)	(pcs.)
M 4	18	35	18	10
M 5	18	35	18	10
M 6	18	35	20	10
M 8	18	35	22	10
M10	18	35	26	10
M12	18	35	30	10
M14	18	35	38	10

183X-75 (XZN)	H (mm)	L (mm)	d (mm)	(g)	(pcs.)
M 4	42.5	75	6	34	10
M 5	42.5	75	6	34	10
M 6	42.5	75	6.2	36	10
M 8	42.5	75	7.4	39	10
M10	42.5	75	9.8	54	10
M12	42.5	75	11.7	57	10
M14	42.5	75	13.5	67	10

183X-150 (XZN)	H (mm)	L (mm)	d (mm)	(g)	(pcs.)
M 5	117.5	150	6	50	10
M 6	117.5	150	6.2	53	10
M 8	117.5	150	7.4	64	10
M10	117.5	150	9.8	93	10
M12	117.5	150	11.7	121	10
M14	117.5	150	13.5	151	10

	□	D ₁ (mm)	D ₂ (mm)	L (mm)	(g)	(pcs.)	⊕
13134	3/8"	24	22	32	70	10	*1
14134	1/2"	24	25	38	90	10	*2
16134	3/4"	24	44	52	200	2	*3

*1 C-Ring=C32,Pin/O-Ring=A32/B32
*2 C-Ring=C41,Pin/O-Ring=A41/B41
*3 C-Ring=C61,Pin/O-Ring=A61/B61

For DIN3126 E11.2 Bits
Für DIN3126 E11.2 Bits
Pour DIN3126 E11.2 Embouts

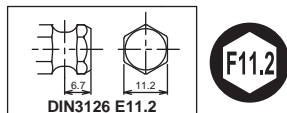

16134-SC

Replacement Screw : M8x6, ● 4mm
Ersatzschraube : M8x6, ● 4mm
Vis de remplacement : M8x6, ● 4mm

	□	D ₁ (mm)	D ₂ (mm)	L (mm)	(g)	(pcs.)	⊕
13142-F11.2	3/8"	18.9	22	46	116	10	*1
14142-F11.2	1/2"	18.9	25	46	207	10	*2

*1 C-Ring=C32,Pin/O-Ring=A32/B32
*2 C-Ring=C41,Pin/O-Ring=A41/B41

For DIN3126 E11.2 Bits
Für DIN3126 E11.2 Bits
Pour DIN3126 E11.2 Embouts

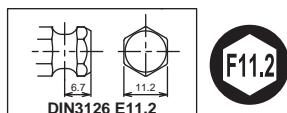

183T-35 / -75 (IP)

TORXplus

TORXPLUS® Bits
TORXPLUS® Bits
Embouts TORXPLUS®

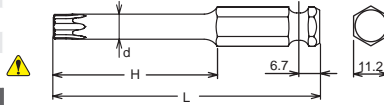

183X-35 / -75 / -150 (XZN)

XZN Bits
XZN Bits
Embouts, XZN

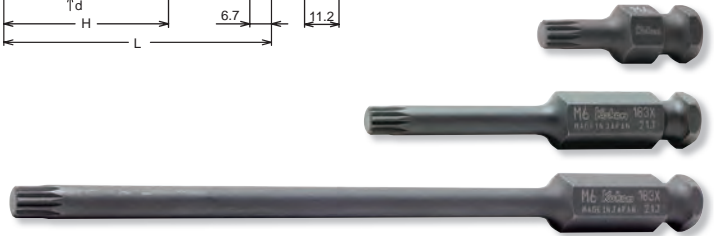
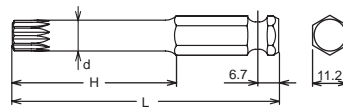

The items with ⚠ have larger output sizes than 7/16" Input drive.
Due to this design the maximum output torque rating is less than standard.

Die mit ⚠ gekennzeichneten Artikel haben größere Abtriebsgrößen als der 7/16" Antrieb.
Aufgrund dieser Konstruktion ist das maximale Abtriebsdrehmoment geringer als der Standardwert.

Les articles marqués d'un ⚠ ont des tailles de sortie plus importantes que l'entraînement d'entrée 7/16".
En raison de cette conception, le couple de sortie maximum est inférieur au couple standard.

13134 14134 16134

Impact Bit Holder
Impact Klingenhalter
Porte embouts Impact

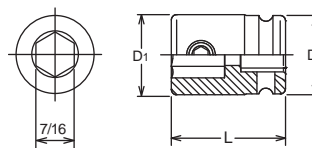

13142-F11.2 14142-F11.2

Impact Bit Holder (Quick Release)
Impact Klingenhalter (Quick Release)
Porte embouts Impact (Quick Release)

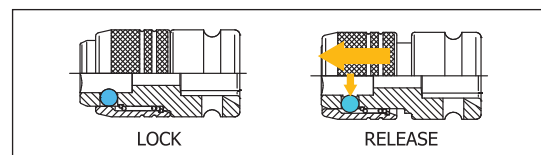
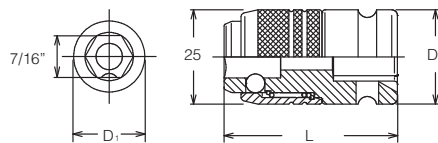

Adaptors with male Square
 Verbindungsteile mit Aussenvierkant
 Adaptateurs avec carré mâle

Z-SERIES
 HAND
 TITANIUM
 ACCESSORIES
 SCREWDRIVERS
 IMPACT
 SLEEVE-DRIVE
 PROTECTOR
 INDUSTRIAL
 AUTOMOTIVE
 MOTORCYCLE
 CONSTRUCTION
 SPARE PART

110-35B / -50B / -75B / -100B / -150B / -200B
-35P / -50P / -75P / -100P / -150P / -200P

Adaptors
 Verbindungsstücke
 Adaptateurs

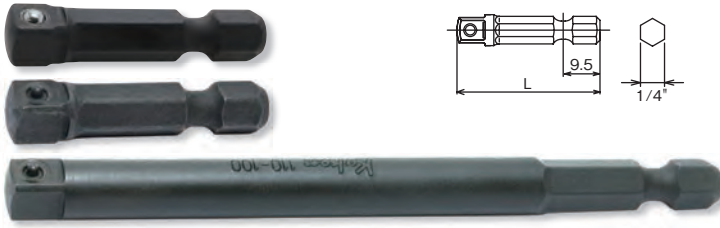

110		TYPE	L (mm)	(g)	(pcs.)
35B	1/4"	Ball	35	9	10
35P		Pin	35	9	10
50B		Ball	50	15	10
50P		Pin	50	15	10
75B		Ball	75	25	10
75P		Pin	75	25	10
100B		Ball	100	34	10
100P		Pin	100	34	10
150B		Ball	150	54	10
150P		Pin	150	54	10
200B		Ball	200	73	10
200P		Pin	200	73	10

DIN 3126 Form E 6.3

110AL-62 / -100 / -150 / -200

Adaptor (Quick Release)
 Schnellwechsel-Verbindungsstück
 Adaptateur autoserrant

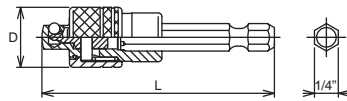

110AL		D (mm)	L (mm)	(g)	(pcs.)
62	1/4"	16.2	62	37	10
100		16.2	100	52	10
150		16.2	150	72	10
200		16.2	200	92	10

DIN 3126 Form E 6.3

You may not hold the sliding part while moving to avoid heating up by friction and reduction by wear.

Bitte das gleitende Teil während der Bewegung nicht festhalten, um eine Erhitzung durch Reibung und durch Verschleiß zu vermeiden.

Vous ne devez pas tenir la partie coulissante pendant le déplacement afin d'éviter l'échauffement par frottement et la réduction par usure la réduction par l'usure.

112-50B / -75B / -100B / -150B / -200B
-50P / -75P / -100P / -150P / -200P

Adaptors
 Verbindungsstücke
 Adaptateurs

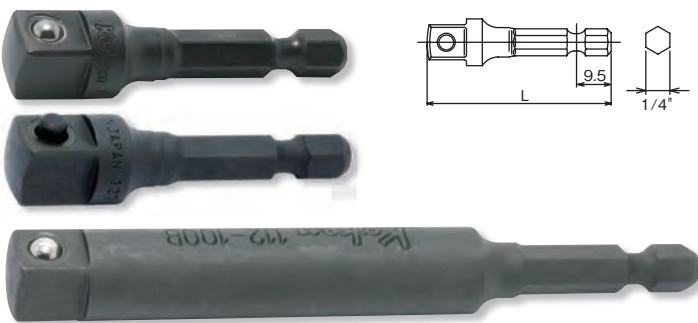

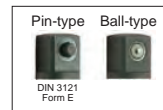

112		TYPE	L (mm)	(g)	(pcs.)
50B	3/8"	Ball	50	21	10
50P		Pin	50	21	10
75B		Ball	75	46	10
75P		Pin	75	46	10
100B		Ball	100	71	10
100P		Pin	100	71	10
150B		Ball	150	121	10
150P		Pin	150	121	10
200B		Ball	200	165	10
200P		Pin	200	165	10

DIN 3126 Form E 6.3



Adaptors with male Square
Verbindungsteile mit Aussenvierkant
Adaptateurs avec carré mâle

Z-SERIES
HAND
TITANIUM
ACCESSORIES
SCREWDRIVERS
IMPACT
SLEEVE-DRIVE
PROTECTOR
INDUSTRIAL
AUTOMOTIVE
MOTORCYCLE
CONSTRUCTION
SPARE PART

112AL  Adaptor (Quick Release)
Schnellwechsel-Verbindungsstück
Adaptateur autoserrant 

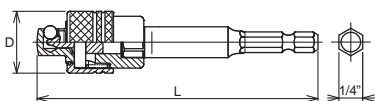

 You may not hold the sliding part while moving to avoid heating up by friction and reduction by wear.

Bitte das gleitende Teil während der Bewegung nicht festhalten, um eine Erhitzung durch Reibung und durch Verschleiß zu vermeiden.

Vous ne devez pas tenir la partie coulissante pendant le déplacement afin d'éviter l'échauffement par frottement et la réduction par usure la réduction par l'usure.

112AL		D (mm)	L (mm)	(g)	(pcs.)
100	3/8"	22	100	95	10

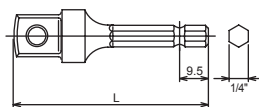

● DIN 3126 Form E 6.3

135E-60B / -60P  Adaptor
Verbindungsstück
Adaptateurs



135E		TYPE	L (mm)	(g)	(pcs.)
60B	1/2"	Ball	60	46	10
60P		Pin	60	46	10

● DIN 3126 Form E 6.3

135AL  Adaptor (Quick Release)
Schnellwechsel-Verbindungsstück
Adaptateur autoserrant 

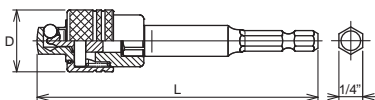

 You may not hold the sliding part while moving to avoid heating up by friction and reduction by wear.

Bitte das gleitende Teil während der Bewegung nicht festhalten, um eine Erhitzung durch Reibung und durch Verschleiß zu vermeiden.

Vous ne devez pas tenir la partie coulissante pendant le déplacement afin d'éviter l'échauffement par frottement et la réduction par usure la réduction par l'usure.

135AL		D (mm)	L (mm)	(g)	(pcs.)
100	1/2"	28	100	160	10

● DIN 3126 Form E 6.3

Adaptors with male Square
Verbindungssteile mit Aussenvierkant
Adaptateurs avec carré mâle

Z-SERIES
HAND
TITANIUM
ACCESSORIES
SCREWDRIVERS
IMPACT
SLEEVE-DRIVE
PROTECTOR
INDUSTRIAL
AUTOMOTIVE
MOTORCYCLE
CONSTRUCTION
SPARE PART

**117-50B / -100B
-50P / -100P**

Adaptors
Verbindungsstücke
Adaptateurs

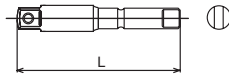

117		TYPE	L (mm)	(g)	(pcs.)
50B	1/4"	Ball	50	15	10
50P		Pin	50	15	10
100B		Ball	100	71	10
100P		Pin	100	71	10

● DIN 3126 Form G7

120-50B / -50P

Adaptor
Verbindungsstück
Adaptateurs

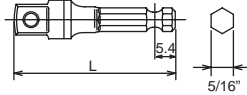

120		TYPE	L (mm)	(g)	(pcs.)
50B	3/8"	Ball	50	27	10
50P		Pin	50	27	10

● DIN 3126 Form E 8

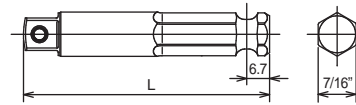

186-75P

Adaptor
Verbindungsstück
Adaptateurs



186		L (mm)	(g)	(pcs.)
75P	3/8"	75	65	10
75P	1/2"	75	85	10

● DIN 3126 Form E 11.2

DIN3126 ISO1173 Bits	C6.3		C8		E6.3		E8		E11.2		G7	
	No.	Page	No.	Page	No.	Page	No.	Page	No.	Page	No.	Page
PH	108P series	166	100P series	168	121P series 123P series	170/172						
PZ			100P(PZ) series	168								
Slotted	108S series	166	100S series	168								
HEX	108H series	166	100H series	168	121H series	170			183H series	176		
HEX (Ball point)									183H-B series	176		
TORX® (T)	108T(T) series	166	100T(T) series	168	121T(T) series	170			183T(T) series	176		
TORX® (TH)	108T(TH) series	166	100T(TH) series	169	121T(TH) series	171						
TORXplus® (IP)					121T(IP) series	171			183T(IP) series	177		
XZN			100X series	169					183X series	177		
6-point					113 series 113UN series	173/175						
MG (with Magnet)					115 series 115G series	174-175					119 series	175
TORX® (E)					113(E) series	173						
ADAPTOR	108A	166			110 series 112 series 135 series	178-179	120 series	180	186 series	180	117 series	180
BIT HOLDER	2137 3137 4137 12139 13139 14139 13142-D6.3 14142-D6.3 180M	167	2138 3138 4138 12140 13140 14140	169	12137E 13137E 14137E 13142-F6.3 14142-F6.3	171			13134 14134 16134 13142-F11.2 14142-F11.2	177		